

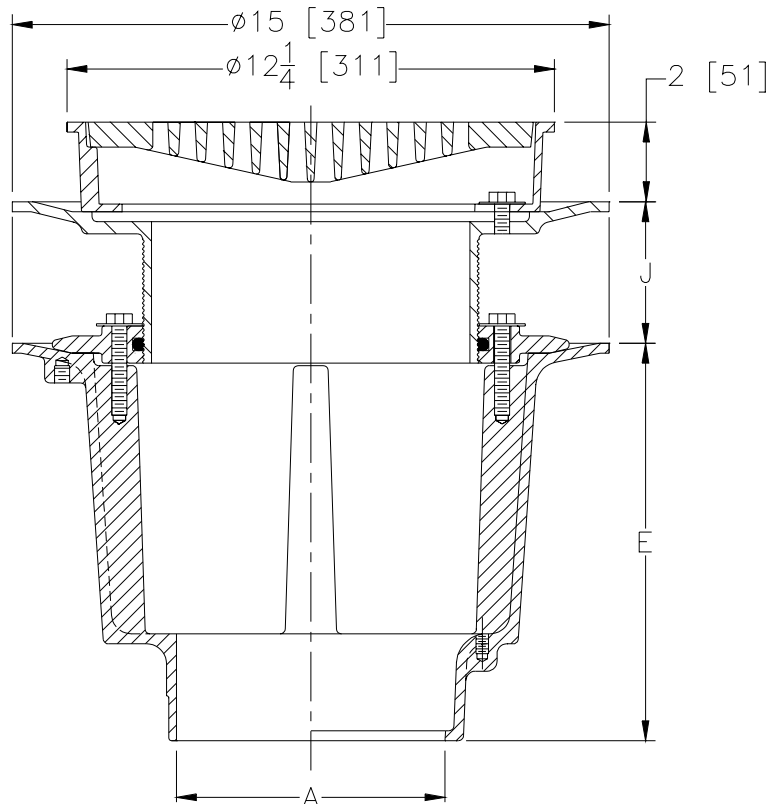

**Z-104-79**  
**15" [381] DIAMETER DEEP SUMP ROOF**  
**DRAIN WITH ADJUSTABLE EXTENSION**

TAG \_\_\_\_\_

Dimensional Data (inches and [ mm ]) are Subject to Manufacturing Tolerances and Change Without Notice



A- Pipe Size In.	Approx. Wt. Lbs. [kg]	Grate Open Area Sq. In. [cm <sup>2</sup> ]
3-4[75-100]	65[29]	30[194]
6-8[150-200]		

**ENGINEERING SPECIFICATION:** ZURN Z-104-79 15 [381] Diameter roof drain. Dura-Coated cast iron deep sump body with combination membrane flashing clamp with adjustable extension and frame for heavy duty grate.

**OPTIONS** (Check/specify appropriate options)

PIPE SIZE	(Specify size/type)	OUTLET	'E' BODY HT. DIM.
3,4,6 [75, 100, 150]	_____	IC Inside Caulk	10 [254]
3,4,6,8 [75, 100, 150, 200]	_____	NH No-Hub	10 [254]

**PREFIXES**

\_\_\_ Z- D.C.C.I.

**SUFFIXES**

- \_\_\_ -AC Angular Underdeck Clamp
- \_\_\_ -AR Acid Resistant Epoxy Coated Finish
- \_\_\_ -C Underdeck Clamp
- \_\_\_ -DX Dex-o-tex Flange
- \_\_\_ -G Galvanized Cast Iron
- \_\_\_ -R Roof Sump Receiver
- \_\_\_ -SC Secondary Clamping Collar
- \_\_\_ -XJ Vertical Expansion Joint
- \_\_\_ -90 90° Threaded Side Outlet Body

REV.	DATE: 08/10/95	C.N. NO. 72618
DWG. NO. P-14222 PRODUCT NO. Z-104-79		

\*REGULARLY FURNISHED UNLESS OTHERWISE SPECIFIED