



# Z356-98

SPECIFICATION SHEET

## MULTI-INLET FLOOR DRAIN W/ INTEGRAL TRAP, W/ 5" SQ. STAINLESS STEEL HEAD W/ POLISHED SLOT COVER

TAG \_\_\_\_\_

Dimensional Data (inches or [ mm ]) are Subject to Manufacturing Tolerances and Change Without Notice

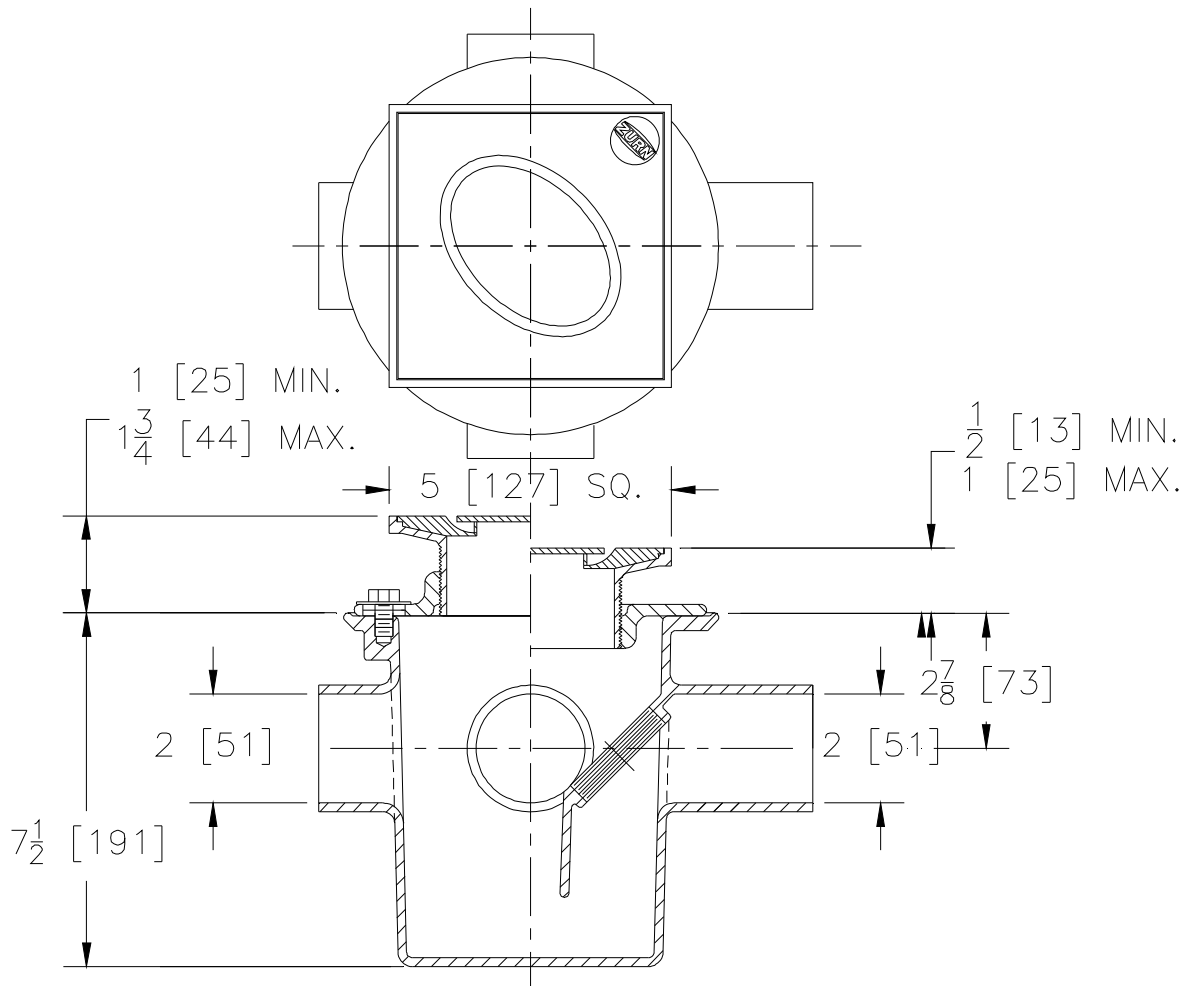

Approx. Wt. Lbs.	Open Area in. <sup>2</sup>
18 [8]	3 [193]

**ENGINEERING SPECIFICATION:** ZURN ZS356-98 Multi-Inlet floor drain with trap, Dura-Coated cast iron body with integral trap seal, complete with plastic cleanout plug, combination invertible membrane clamp and adjustable collar with seepage slots, and discretely secured 5" [127] square, polished stainless steel adjustable top with oval slot opening.

**OPTIONS** (Check/specify appropriate options)

**OUTLET**  
 \_\_\_\_\_ NH No-Hub  
 \_\_\_\_\_ PIPE SIZE (Specify size)  
 \_\_\_\_\_ 2 [51]

**PREFIXES**

\_\_\_\_\_ ZS D.C.C.I. Body w/ Type 304 (CF8) Stainless Steel Top\*  
 \_\_\_\_\_ ZM D.C.C.I. Body w/ Type 316 (CF8M) Stainless Steel Top  
 \_\_\_\_\_ ZL D.C.C.I. Body w/ Type 316L (CF3M) Stainless Steel Top

**SUFFIXES**

\_\_\_\_\_ -BP Bronze Plug  
 \_\_\_\_\_ -G Galvanized Cast Iron  
 \_\_\_\_\_ -J Auxiliary Inlet Connection (Opposite Outlet)  
 \_\_\_\_\_ -J2 Two Auxiliary Inlet Connections  
 (1 Opposite Outlet, 1 Left Side Facing Outlet)  
 \_\_\_\_\_ -J3 Three Auxiliary Inlet Connections  
 \_\_\_\_\_ -U 1-3 [25-76] High Extension Adapter

\*REGULARLY FURNISHED UNLESS OTHERWISE SPECIFIED

REV. A	DATE: 11/9/11	C.N. NO. 122414
DWG. NO. 308176		PRODUCT NO. Z356-98