



# Z888-12-DYN-PSF

SPECIFICATION SHEET

HI-CAP SLOTTED DRAINAGE SYSTEM  
FOR DYNAMIC LOADING APPLICATION WITH PRE-SLOPED FRAME  
FOR 12 [305] CORRUGATED PIPE OR EQUIVALENT

TAG \_\_\_\_\_

Dimensional Data (inches and [ mm ]) are Subject to Manufacturing Tolerances and Change Without Notice

Specifying engineer is responsible for concrete encasement and reinforcing based upon application and local codes.

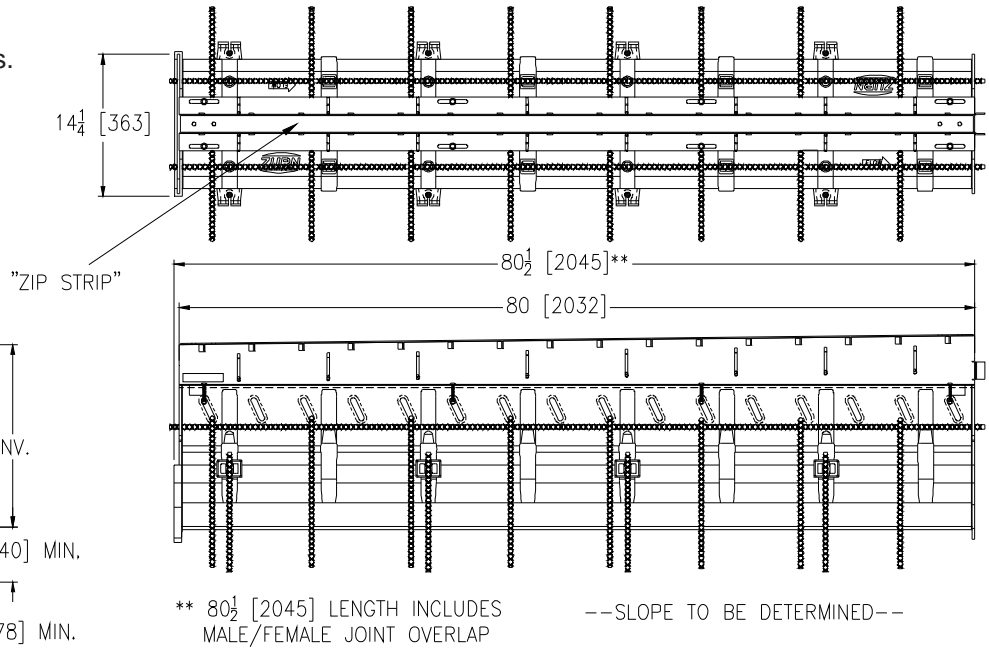
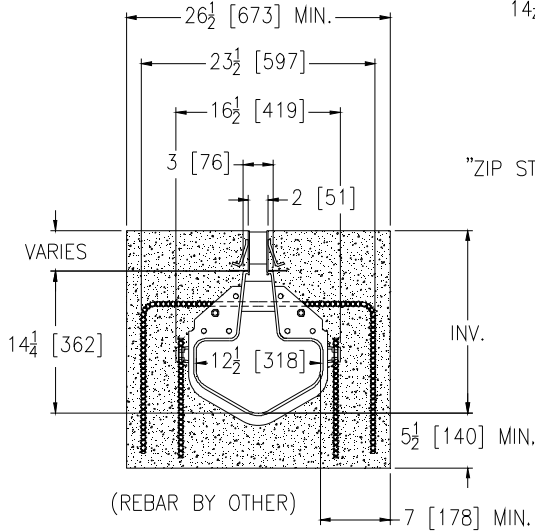

**ENGINEERING SPECIFICATION:** Zurn Z888-12-PSF-DYN Slotted Drain channel is 80[2032] long and 12.5[318] wide with a 1.75[44] throat width, made from LLDPE linear Low Density Polyethylene. Channels have a mechanical tongue and groove and bolted connection, mechanically lock into the concrete surround every 5[127] along its length, channels weigh 5.6 lbs. per foot [8.3 kg per meter]. Channel has a smooth 2.5[64] radiused bottom with a smooth .011 Manning's coefficient, and neutral non-sloping body. Top reveal is non removable and is the finish at the surface. System is anchored into the concrete with Rebar clips or physical anchors every 5[127] to 10[254] along the channel body. Integral Rebar Clips are standard. PSF Frame rails shall be fabricated steel conforming to ASTM 36/A36M-93a, shall have concrete anchors 0.25 [6] diameter x 3 [76] in length on 12 [305] centers to form a mechanical lock to the encasement, shall have a slope built in. Slope will be with a beginning height minimum of 2 [51], and a maximum ending height of 20 [508], overall invert range from 16.25 [413] to 34.25 [870], shall be e-coated and meet ASTM B-117 3000hr salt spray test, and shall be fabricated by certified welder per ASTM AWS D1.1. Minimum 4000psi concrete encasement shall include "n" shaped #4 0.5 [13] rebar through the system neck every 10 [254], and longitudinal #4 0.5 [13] rebar along chairs on either side of the trench neck. System is capable of Supporting Class E Loading per DIN EN1433 top load classifications.

### PREFIX OPTIONS

\_\_\_\_\_ Z 80 [2032] linear low density polyethylene modular drain channel with integral top frame.\*

### SUFFIX OPTIONS

- \_\_\_\_\_ -E1 End Cap
- \_\_\_\_\_ -E4 4 [102] No Hub End Outlet
- \_\_\_\_\_ -E6 6 [152] No Hub End Outlet
- \_\_\_\_\_ -E8 8 [203] No Hub End Outlet
- \_\_\_\_\_ -E12 12 [305] No Hub End Outlet
- \_\_\_\_\_ -T12/18 Transition from -12 [305] to -18 [457]
- \_\_\_\_\_ -T18/12 Transition from -18 [457] to -12 [305]

REV. A	DATE: 10/04/10	C.N. NO. 111772
DWG. NO. 302136	PRODUCT NO. Z888-12-DYN-PSF	

\*Regularly Furnished Unless Otherwise Specified