



# Z415N-81

## BODY ASSEMBLY

### W/ "TYPE N" STRAINER & CHAINED GRATE

SPECIFICATION SHEET

TAG \_\_\_\_\_

Dimensional Data (inches and [ mm ]) are Subject to Manufacturing Tolerances and Change Without Notice

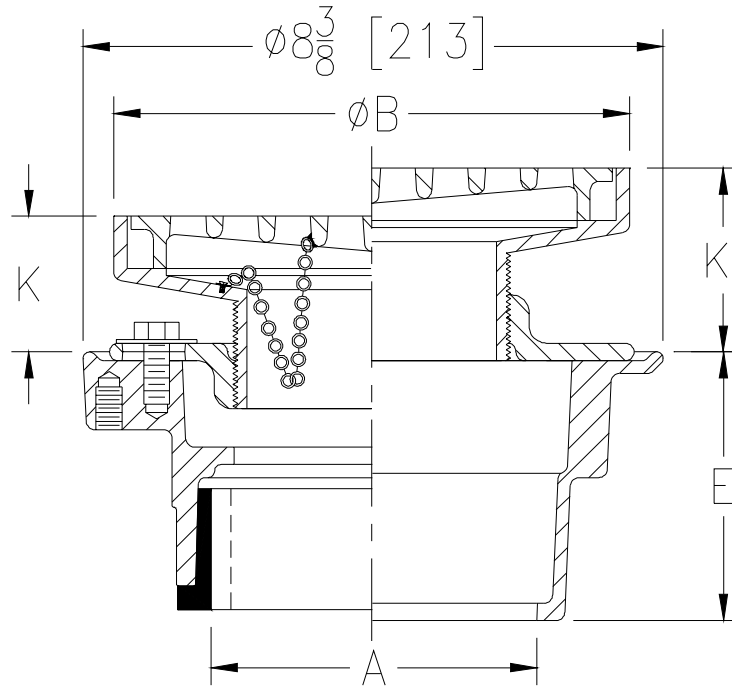

Dimensions In Inches						Approx. Wt. Lbs. [kg]	Strainer Open Area Sq. In. [cm <sup>2</sup> ]
A - Pipe Size	B Strainer Dia.	K		K'			
		Min.	Max.	Min.	Max.		
2-3-4 [51-76-102]	7 [178]	1 1/8 [29]	2 3/8 [60]	1 3/4 [44]	2 7/8 [73]	17 [8]	12 [77]
2-3-4 [51-76-102]	9 [229]	1 5/8 [41]	2 5/8 [67]	2 1/4 [57]	3 1/2 [89]	21 [10]	23 [148]
6 [152]	9 [229]	1 5/8 [41]	2 5/8 [67]	2 1/4 [57]	3 1/2 [89]	23 [10]	23 [148]

**ENGINEERING SPECIFICATION:** ZURN Z415N-81 Floor and shower drain, Dura-Coated cast iron body with bottom outlet, combination invertible membrane clamp and adjustable collar with "TYPE N" D.C.C.I. strainer with deep flanged chained grate.

**OPTIONS** (Check/specify appropriate options)

PIPE SIZE	(Specify size/type) OUTLET	'E' BODY HT. DIM.
2 thru 4 [51 thru 102]	_____ IC Inside Caulk	3 7/8 [98]
2 [51]	_____ IP Threaded	2 3/8 [60]
3 [76]	_____ IP Threaded	2 5/8 [67]
4 [102]	_____ IP Threaded	2 7/8 [73]
6 [152]	_____ IP Threaded	2 3/4 [70]
2 thru 4 [51 thru 102]	_____ NH No-Hub	3 7/8 [98]
2 thru 4 [51 thru 102]	_____ NL Neo-Loc	3 3/4 [95]

**PREFIXES**

- \_\_\_\_\_ Z D.C.C.I. Body Assembly w/Dura-Coated Top\*
- \_\_\_\_\_ ZB D.C.C.I. Body Assembly w/Polished Bronze Top
- \_\_\_\_\_ ZN D.C.C.I. Body Assembly w/Polished Nickel Bronze Top

**SUFFIXES**

- \_\_\_\_\_ -AR Acid Resisting Epoxy Coated Cast Iron
- \_\_\_\_\_ -DG Duresist Grate
- \_\_\_\_\_ -G Galvanized Cast Iron
- \_\_\_\_\_ -TC Neo-Loc Test Cap Gasket  
( 2 - 4 [51 - 76] NL Bottom Outlet Only)
- \_\_\_\_\_ -TS Top Secured with Slotted Screws
- \_\_\_\_\_ -P Trap Primer Connection (Specify 1/2 [13] or 3/4 [19])
- \_\_\_\_\_ -U 1 - 3 [25 - 76] High Extension Adapter
- \_\_\_\_\_ -VP Vandal-Proof Secured Top
- \_\_\_\_\_ -90 2 or 3 [51 or 76] Side Outlet Body Assembly

\*REGULARLY FURNISHED UNLESS OTHERWISE SPECIFIED

<b>REV.</b>	<b>DATE: 8/6/04</b>	<b>C.N. NO. 92444</b>
<b>DWG. NO. P-15076 PRODUCT NO. Z415N-81</b>		