

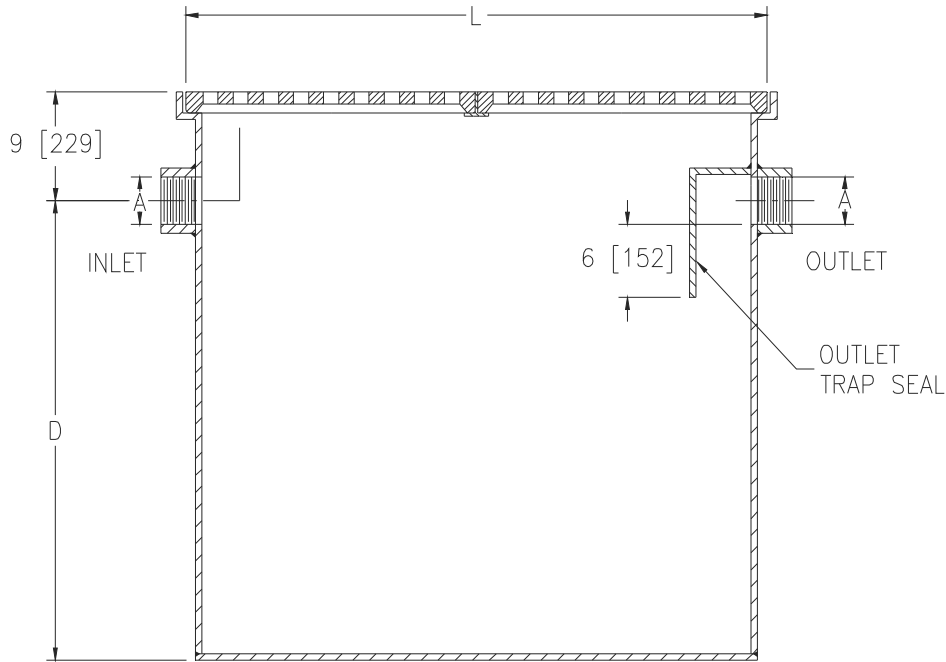

**Z1187-SI-123**  
**SIZE 20 SAND INTERCEPTOR**

Dimensional Data (inches and [mm]) are Subject to Manufacturing Tolerances and Change Without Notice



Size	Flow G.P.M. [LPM] (Max.)	Dimensions In In. [mm]			Capacity Gal. [L] (Static)	No. of 12 x 24 [305 x 610] Grates	Width In [mm]	Approx. Wt. Lbs. [Kg]
		A Pipe Size	L	D				
20	20 [76]	4 [102]	24 [610]	26 [660]	60 [227]	2	24 [610]	133 [60]

**ENGINEERING SPECIFICATION: ZURN Z1187-SI-123**

Size 20 Acid Resistant Coated interior and exterior, fabricated steel sand interceptor with threaded inlet and outlet, complete with removable heavy-duty grates.

**OPTIONS** (Check/specify appropriate options)

**PREFIXES**

\_\_\_ Z Acid Resistant Coated Fabricated Steel\*

**SUFFIXES**

- \_\_\_ -E Integral Extension Assembly (Specify extension height)
- \_\_\_ -DG Duresist Grate
- \_\_\_ -K Anchor Flange 1-3/4 [44] down from top and 2 [51] wide. No extension required to accommodate -K option.
- \_\_\_ -KC Anchor Flange 1-3/4 [44] down from top and 2 [51] wide with clamp collar. No extension required to accommodate -KC option.
- \_\_\_ -NH No-Hub Inlet and Outlet (Z1040)
- \_\_\_ -SC Heavy-Duty Reinforced Cover(s) rated at 10,000 lbs. [4536 Kg.] maximum safe live load.
- \_\_\_ -VP Vandal-Proof Screws

\* Regularly furnished unless otherwise specified.