



Z415-154 BODY ASSEMBLY W/ INVERTIBLE CLAMP COLLAR

SPECIFICATION SHEET

TAG _____

Dimensional Data (inches and [mm]) are Subject to Manufacturing Tolerances and Change Without Notice

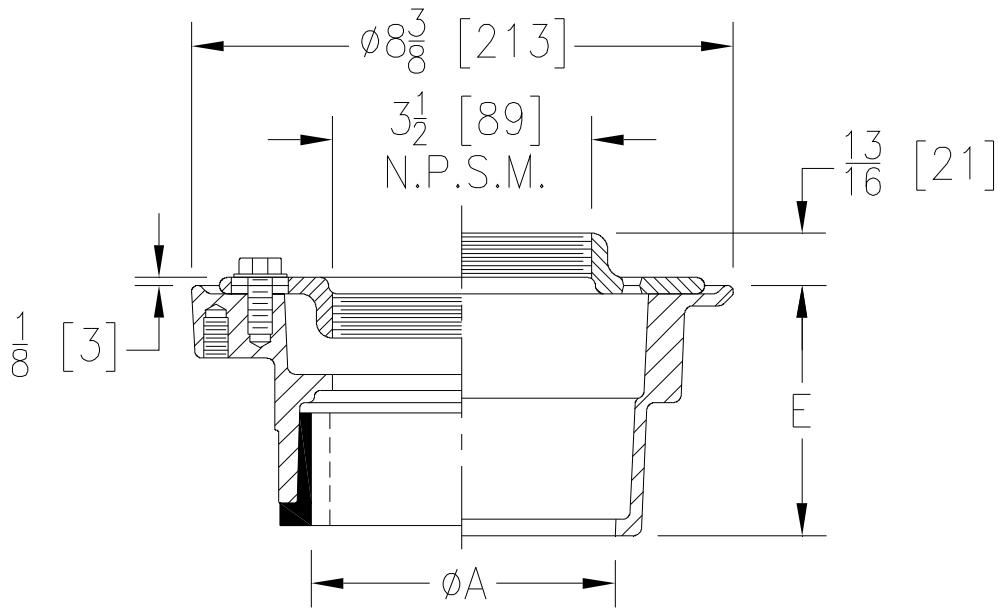

Dimensions In Inches A Pipe Size	Approx. Wt. Lbs. [kg]
2-3-4 [51-76-102]	9 [4]
6 [152]	12 [5]

ENGINEERING SPECIFICATION: ZURN Z415-154

Floor and shower drain, Dura-Coated cast iron body with bottom outlet, and combination invertible membrane clamp.

OPTIONS (Check/specify appropriate options)

PIPE SIZE

- 2 thru 4 [51 thru 102]
- 2 thru 4 [51 thru 102]
- 2 [51]
- 3 [76]
- 4 [102]
- 6 [152]
- 2 thru 4 [51 thru 102]
- 2 thru 4 [51 thru 102]

(Specify size/type) **OUTLET**

- ___ IC Inside Caulk
- ___ IG Inside Gasket
- ___ IP Threaded
- ___ IP Threaded
- ___ IP Threaded
- ___ IP Threaded
- ___ NH No-Hub
- ___ NL Neo-Loc

'E' BODY HT. DIM.

- 3 7/8 [98]
- 3 7/8 [98]
- 2 3/8 [60]
- 2 5/8 [67]
- 2 7/8 [73]
- 2 3/4 [70]
- 3 7/8 [98]
- 3 3/4 [95]

PREFIXES

- ___ Z D.C.C.I. Body and Collar

SUFFIXES

- ___ -AR Acid Resisting Epoxy Coated Cast Iron
- ___ -G Galvanized Cast Iron
- ___ -P Trap Primer Connection (Specify 1/2 [13] or 3/4 [19])
- ___ -U 3 [76] High Extension Adapter
- ___ -90 90° Threaded Side Outlet Body (2, 3 [51, 76] Only)

REV.	DATE: 4/24/06	C.N. NO. 95049
DWG. NO. P-15270 PRODUCT NO. Z415-154		

*REGULARLY FURNISHED UNLESS OTHERWISE SPECIFIED