



Z-512-76

12" [305] HEAVY DUTY DRAIN WITH TRACTOR GRATE

TAG _____

Dimensional Data (inches and [mm]) are Subject to Manufacturing Tolerances and Change Without Notice

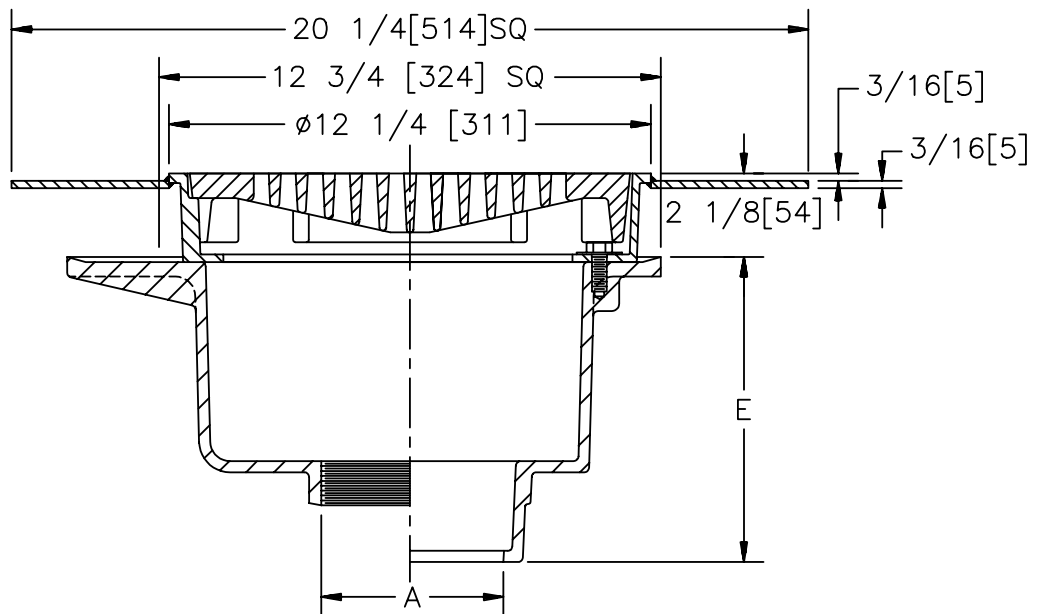

A- Pipe Size In.	Approx. Wt. Lbs. [kg]	Grate Open Area Sq. In. [cm ²]
3-4 [75-100]	46 [21]	30 [194]

ENGINEERING SPECIFICATION: ZURN Z-512-76 12 [305] Diameter top heavy duty drain, Dura-Coated cast iron deep sump body with dex-o-tex flange and bottom outlet, seepage pan and combination flashing clamp and frame for heavy duty tractor grate.

OPTIONS (Check/specify appropriate options)

PIPE SIZE	(Specify size/type) OUTLET	'E' BODY HT. DIM.
3, 4 [75, 100]	___ IC Inside Caulk	7 3/4 [197]
3, 4 [75, 100]	___ IG Inside Caulk w/Sealtrol Gskt.	7 3/4 [197]
3 [75]	___ IP Threaded	6 [152]
4 [100]	___ IP Threaded	6 1/4 [159]
3, 4 [75, 100]	___ NL Neo-Loc	7 1/4 [184]

PREFIXES

- ___ Z- D.C.C.I. Body and Grate*
- ___ ZB- D.C.C.I. Body with Polished Bronze Grate (Add 3/16 [5] to 2 1/8 [54] Dim.)
- ___ ZN- D.C.C.I. Body with Polished Nickel Bronze Grate (Add 3/16 [5] to 2 1/8 [54] Dim.)

SUFFIXES

- ___ -DG Duresist Grate
- ___ -G Galvanized Cast Iron
- ___ -PH Grate with 3/8 [10] Diameter Opening (Z only)
- ___ -S Secondary Strainer
- ___ -T Square Top
- ___ -V Backwater Valve (See Z-1099)
- ___ -VP Vandal Proof Secured Top
- ___ -Y Sediment Bucket
- ___ -90 90° Threaded Side Outlet Body

REV.	DATE: 09/01/95	C.N. NO. 72706
DWG. NO. P-14233 PRODUCT NO. Z-512-76		

*REGULARLY FURNISHED UNLESS OTHERWISE SPECIFIED