



Z566-93
12 [305] HEAVY-DUTY DRAIN
WITH DURESIST GRATE

SPECIFICATION SHEET

TAG _____

Dimensional Data (inches and [mm]) are Subject to Manufacturing Tolerances and Change Without Notice

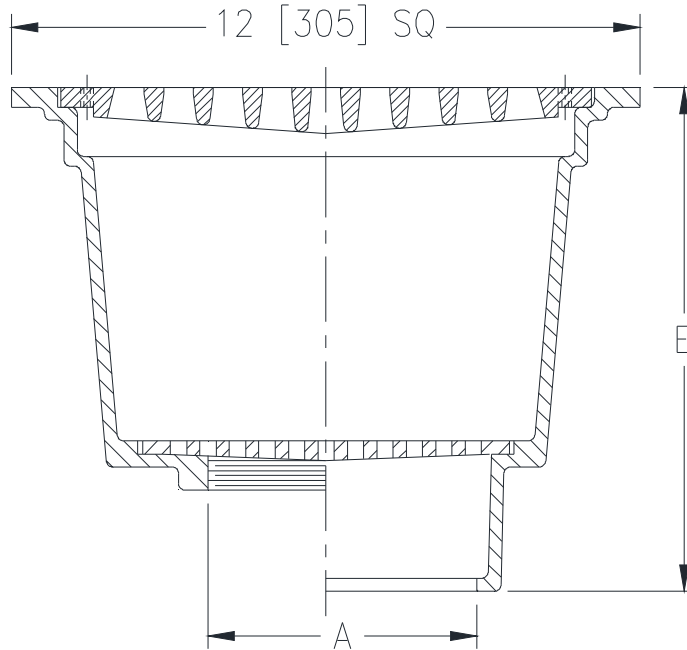

A - Pipe Size Inches [mm]	Approx. Wt. Lbs. [kg]	Open Area [Sq. In.]
2,3,4 [51,76,102]	51 [23]	37.4 [241]

ENGINEERING SPECIFICATION: ZURN Z566-93

12 [305] Square drain, Dura-Coated cast iron body with bottom outlet, loose set cast iron secondary strainer, and Heavy-Duty Duresist Top Grate.

OPTIONS (Check/specify appropriate options)

PIPE SIZE

- 2, 3, 4 [51, 76, 102]
- 2, 3, 4 [51, 76, 102]
- 3, 4 [76, 102]
- 2, 3, 4 [51, 76, 102]

(Specify size/type) **OUTLET**

- ___ IC Inside Caulk
- ___ IG Inside Gasket
- ___ IP Threaded
- ___ NL Neo-Loc

'E' BODY HT. DIM.

- 9-5/8 [244]
- 9-5/8 [244]
- 7-5/8 [194]
- 9 [229]

PREFIXES

- ___ Z D.C.C.I. Body and Top*
- ___ ZB D.C.C.I. Body with Polished Bronze Top (Add 3/16 [5] to 'E' Dim.)
- ___ ZN D.C.C.I. Body with Polished Nickel Bronze Top (Add 3/16 [5] to 'E' Dim.)

SUFFIXES

- ___ -AR Acid Resisting Epoxy Coated Cast Iron
- ___ -BT Bell Trap Bucket
- ___ -G Galvanized Cast Iron
- ___ -TC Neo-Loc Test Cap Gasket
(2 [51] - 4 [102] NL Bottom Outlet Only)
- ___ -Y Sediment Bucket

* Regularly furnished unless otherwise specified.