



Z187-FG

6-3/8 X 7-1/2 [162 X 191] OR 8-3/8 X 12-1/2 [213 X 318]
SCUPPER DRAIN WITH FLUSH GRATE

SPECIFICATION SHEET

TAG _____

Dimensional Data (inches and [mm]) are Subject to Manufacturing Tolerances and Change Without Notice

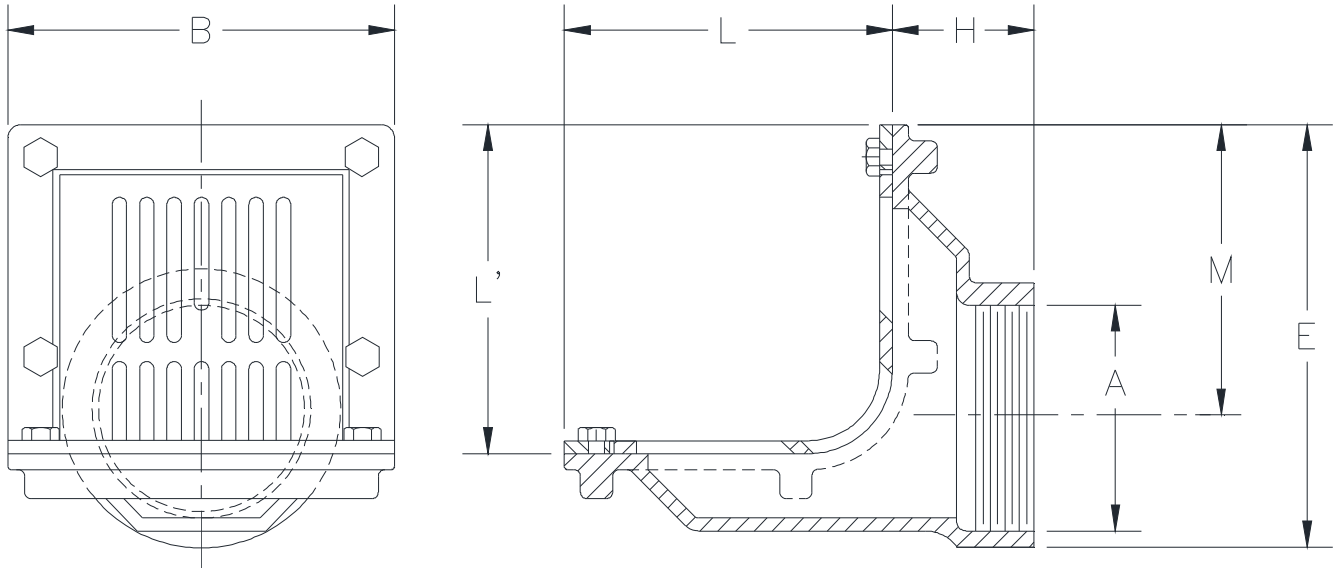

Dimensions In Inches [mm]						Approx. Wt. Lbs. [kg]	Grate Open Area Sq. In. [cm ²]
A-Pipe Size	B	H	L	L'	M		
2 [51]	7-1/2 [191]	2-3/4 [70]	6-3/8 [162]	6-3/8 [162]	6-5/8 [168]	22 [10]	20 [129]
3 [76]					6-1/8 [156]		
4 [102]					5-5/8 [143]		
6 [152]	12-1/2 [318]	3-1/2 [89]	8-3/8 [213]	8-3/8 [213]	7-7/8 [200]	32 [15]	57 [368]
8 [203]					7-3/8 [187]		

ENGINEERING SPECIFICATION: ZURN Z187-FG

6-3/8" x 7-1/2" [162mm x 191mm] or 8-3/8" x 12-1/2" [213mm x 318mm] Scupper drain, Dura-Coated cast iron body with reversible back or bottom outlet, flush grate with 90° combination frame and membrane flashing clamp.

OPTIONS (Check/specify appropriate options)

PIPE SIZE

2, 3, 4 [51, 76, 102]
6, 8 [152, 203]

(Specify size/type) **OUTLET**

___ IP Threaded
___ IP Threaded

'E' BODY HT. DIM.

8-1/8 [206]
11 [279]

PREFIXES

___ Z D.C.C.I. Body with Grate*
___ ZN D.C.C.I. Body with Polished Nickel Bronze Grate

SUFFIXES

___ -BS Bronze Mesh Screen Over Grate
___ -G Galvanized Cast Iron
___ -VP Vandal-Proof Secured Top

* Regularly furnished unless otherwise specified.