



**Z350-81**

PLANTING AREA DRAIN WITH 2 [51] STANDPIPE

SPECIFICATION SHEET

TAG \_\_\_\_\_

Dimensional Data (inches and [ mm ]) are Subject to Manufacturing Tolerances and Change Without Notice

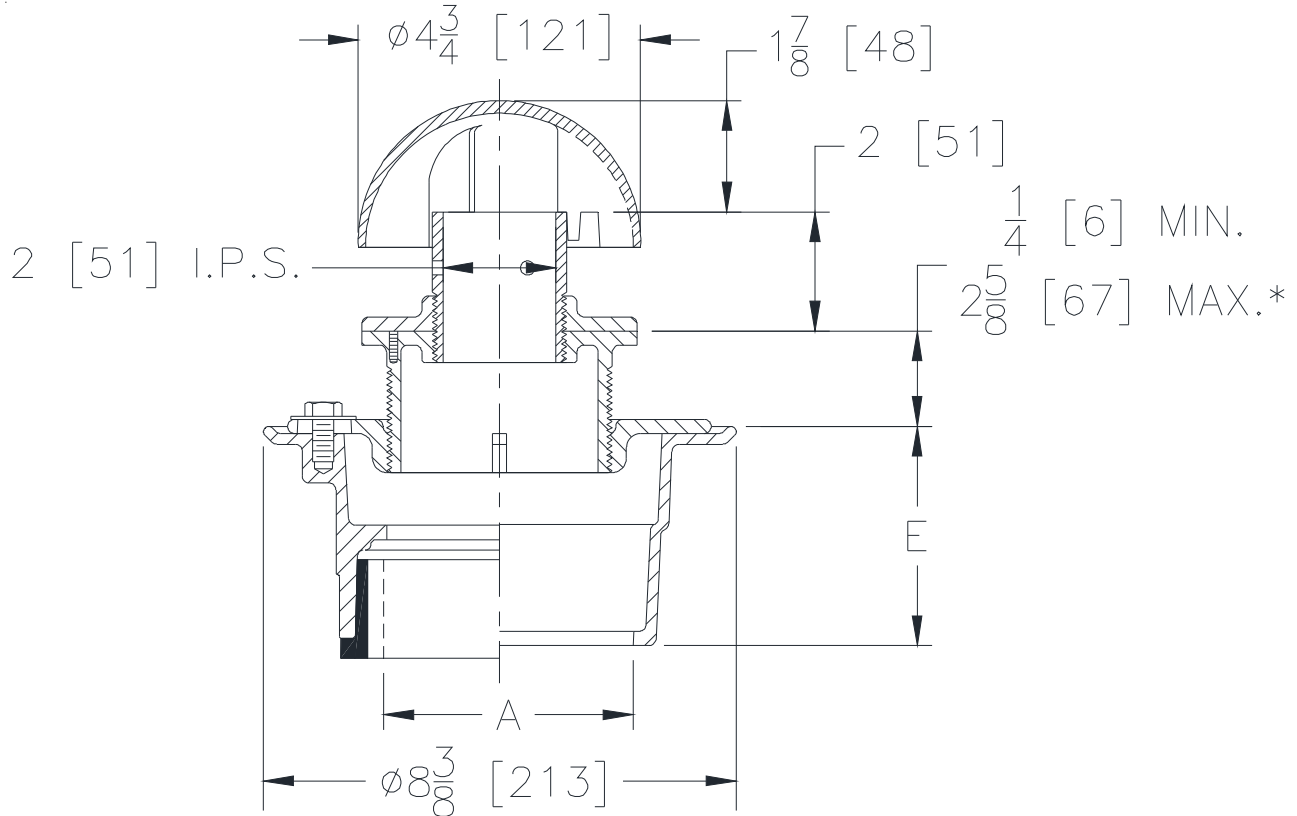

A-Pipe Size Inches [mm]	Approx. Wt. Lbs. [kg]
2, 3, 4 [51, 76, 102]	22 [10]

**ENGINEERING SPECIFICATION: ZURN Z350-81**

Planting area drain, Dura-Coated cast iron body with bottom outlet and combination invertible membrane clamp, vertically adjustable nickel bronze head, floor flange, dome with 2" [51] tall and 2" [51 mm] diameter perforated stainless steel standpipe.

**OPTIONS** (Check/specify appropriate options)

**PIPE SIZE**

- 2, 3, 4 [51, 76, 102]
- 2, 3, 4 [51, 76, 102]
- 2 [51]
- 3 [76]
- 4 [102]
- 2, 3, 4 [51, 76, 102]
- 2, 3, 4 [51, 76, 102]

(Specify size/type) **OUTLET**

- \_\_\_ IC Inside Caulk
- \_\_\_ IG Inside Gasket
- \_\_\_ IP Threaded
- \_\_\_ IP Threaded
- \_\_\_ IP Threaded
- \_\_\_ NH No-Hub
- \_\_\_ NL Neo-Loc

**'E' BODY HT. DIM.**

- 3-7/8 [98]
- 3-7/8 [98]
- 2-3/8 [60]
- 2-5/8 [67]
- 2-7/8 [73]
- 3-7/8 [98]
- 3-3/4 [95]

**PREFIXES**

- \_\_\_ ZB D.C.C.I Body w/ Polished Brass Standpipe
- \_\_\_ ZN D.C.C.I Body w/ Polished Stainless Steel Standpipe\*

**SUFFIXES**

- \_\_\_ -C Underdeck Clamp
- \_\_\_ -G Galvanized Cast Iron
- \_\_\_ -P Trap Primer Connection  
(Specify 1/2 [13] or 3/4 [19])

- \_\_\_ -PS Solid Standpipe
- \_\_\_ -SS Stainless Steel Mesh Screen over Dome

\* Regularly furnished unless otherwise specified.