



# Z1186-ST-94

## OIL INTERCEPTOR W/ INTEGRAL 100 [379] GALLON STORAGE TANK

SPECIFICATION SHEET

TAG \_\_\_\_\_

Dimensional Data (inches and [ mm ]) are Subject to Manufacturing Tolerances and Change Without Notice

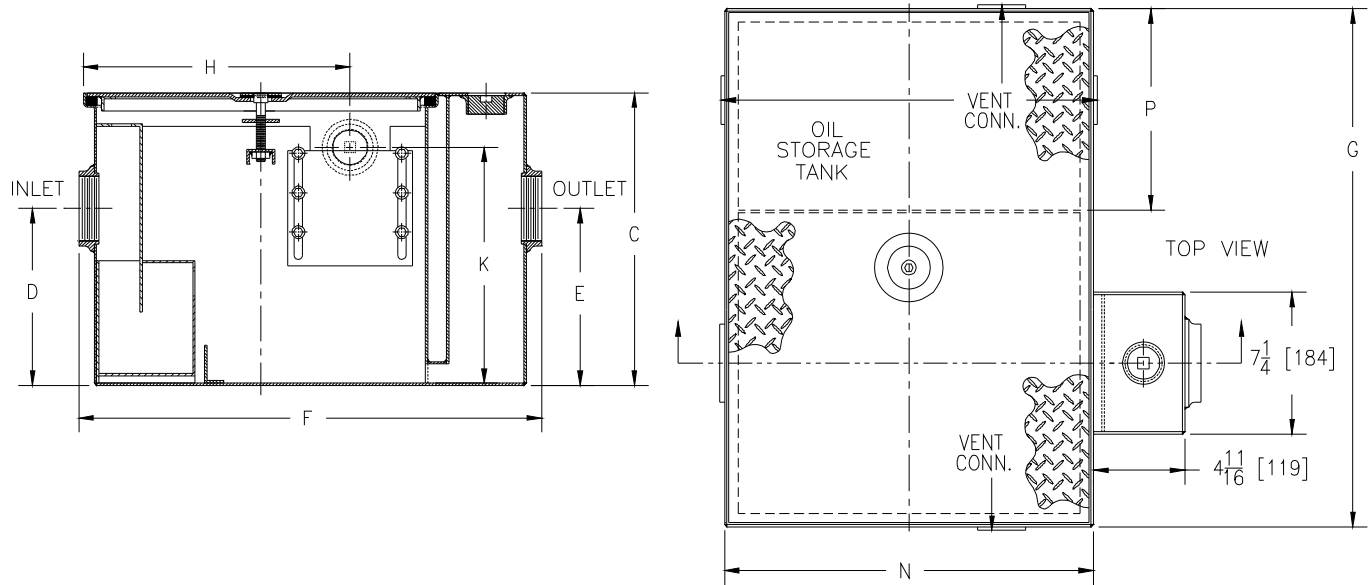

Size	Inlet/Outlet Size	Flow Rate G.P.M.	Water Capacity Gal. [L]	Approx. Wt. Lbs. [kg]	P
700	3 [76]	35 [132]	21 [79]	320 [145]	46 11/16 [1186]

Dimensions in inches [mm]								Oil Storage Tank Capacity Gal. [L]	No. of Covers
Size	C	D/E	F	G	H	K	N		
700	19 3/4 [502]	12 7/16 [316]	43 7/16 [1103]	66 [1676]	23 1/4 [591]	16 3/4 [425]	37 [940]	100 [379]	3

**ENGINEERING SPECIFICATION:** ZURN Z1186-ST Acid Resistant Coated interior and exterior fabricated steel oil interceptor, with bronze cleanout plug and visible double wall trap seal, removable combination pressure equalizing/flow diffusing baffle and sediment bucket, oil drawoff, vent connections, secured gasketed non-skid cover, complete with flow control fitting and left hand integral storage tank. Regularly furnished with inlet and outlet in high position. Note: location of outlet from bottom of interceptor cannot be changed.

**OPTIONS** (Check/specify appropriate options)

**PREFIXES**

\_\_\_\_\_ **Z** Acid Resistant Coated Fabricated Steel\*

**SUFFIXES**

\_\_\_\_\_ **-E** Acid Resistant Coated interior and exterior fabricated steel section. (Specify 'C' Dim. required) for recessed installation

\_\_\_\_\_ **-HD** Heavy duty traffic cover rated at 10,000 lbs. maximum safe live load.

\_\_\_\_\_ **-K** Anchor flange 1 3/4 [44] down from top and 2 [51] wide. A 3 [76] minimum extension height is required when anchor flange (-K) option is specified. (Specify 'C' Dim. height required.)

\_\_\_\_\_ **-KC** Anchor flange 1 3/4 [44] down from top and 2 [51] wide with clamp collar.

\_\_\_\_\_ **-STR** Storage tank on right hand side when facing the inlet.

\*\* Inlet and outlet sizes shown indicate standard operating sizes and flow control settings. Size #300 and #400 will have 3 [76] connections reduced to 2 [51] as standard. Size #700 and #800 will have 4 [100] connections reduced to 3 [76] as standard.

**REV.**      **DATE:** 3/10/10      **C.N. NO.** 110817

**DWG. NO.** P-15850    **PRODUCT NO.** Z1186-ST-94

\*REGULARLY FURNISHED UNLESS OTHERWISE SPECIFIED