



**Z-187-86**  
**6" X 7" [152 X 178]**  
**OBLIQUE SCUPPER DRAIN**

SPECIFICATION SHEET

TAG \_\_\_\_\_

Dimensional Data (inches and [ mm ]) are Subject to Manufacturing Tolerances and Change Without Notice

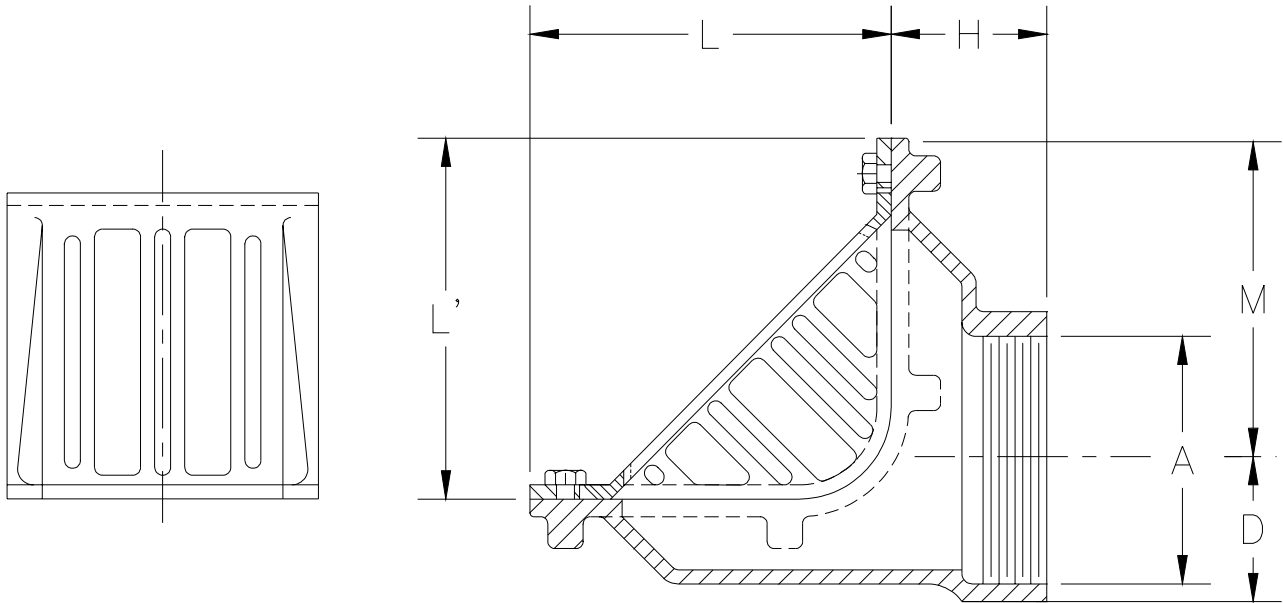

A-Pipe Size Inches	Dimensions In Inches [mm]						Approx. Wt. Lbs. [kg]	Grate Open Area Sq. In. [cm <sup>2</sup> ]
	B	D	H	L	L'	M		
3 [75]	7 1/2 [191]	1 1/2 [38]	2 3/4 [70]	6 3/8 [162]	6 3/8 [162]	6 5/8 [168]	22 [10]	25 [161]
4 [100]		2 [51]				6 1/8 [156]		
5 [125]		2 1/2 [64]				5 5/8 [143]		

**ENGINEERING SPECIFICATION:** ZURN Z-187-86 6 x 7 [152 x 178] Scupper drain, Dura-Coated cast iron body with reversible back or bottom outlet, oblique aluminum grate with 90° combination frame and membrane flashing clamp.

**OPTIONS** (Check/specify appropriate options)

**PIPE SIZE**

2 thru 4 [50 thru 100]  
 (IP w/Z-1040)

(Specify size/type) **OUTLET**

\_\_\_\_\_ IP Threaded  
 \_\_\_\_\_ NH No-Hub

**'E' BODY HT. DIM.**

See Chart  
 See Chart

**PREFIXES**

- \_\_\_\_\_ Z- D.C.C.I. Body with Grate\*
- \_\_\_\_\_ ZB- D.C.C.I. Body with Polished Bronze Grate
- \_\_\_\_\_ ZN- D.C.C.I. Body with Polished Nickel Bronze Grate
- \_\_\_\_\_ ZRB- D.C.C.I. Body with Plain Bronze Grate

**SUFFIXES**

- \_\_\_\_\_ -BS Bronze Mesh Screen Over Grate
- \_\_\_\_\_ -DA Downspout Adapter
- \_\_\_\_\_ -FG Flush Grate
- \_\_\_\_\_ -G Galvanized Cast Iron
- \_\_\_\_\_ -TS Secured Top With Slotted Screws
- \_\_\_\_\_ -VP Vandal Proof Secured Top

\*REGULARLY FURNISHED UNLESS OTHERWISE SPECIFIED

<b>REV. A</b>	<b>DATE: 9/23/98</b>	<b>C.N. NO. 81236</b>
<b>DWG. NO. P-14668 PRODUCT NO. Z-187-86</b>		