



Z-1090-76

BACKWATER VALVE FLAPPER TYPE

SPECIFICATION SHEET

TAG _____

Dimensional Data (inches and [mm]) are Subject to Manufacturing Tolerances and Change Without Notice

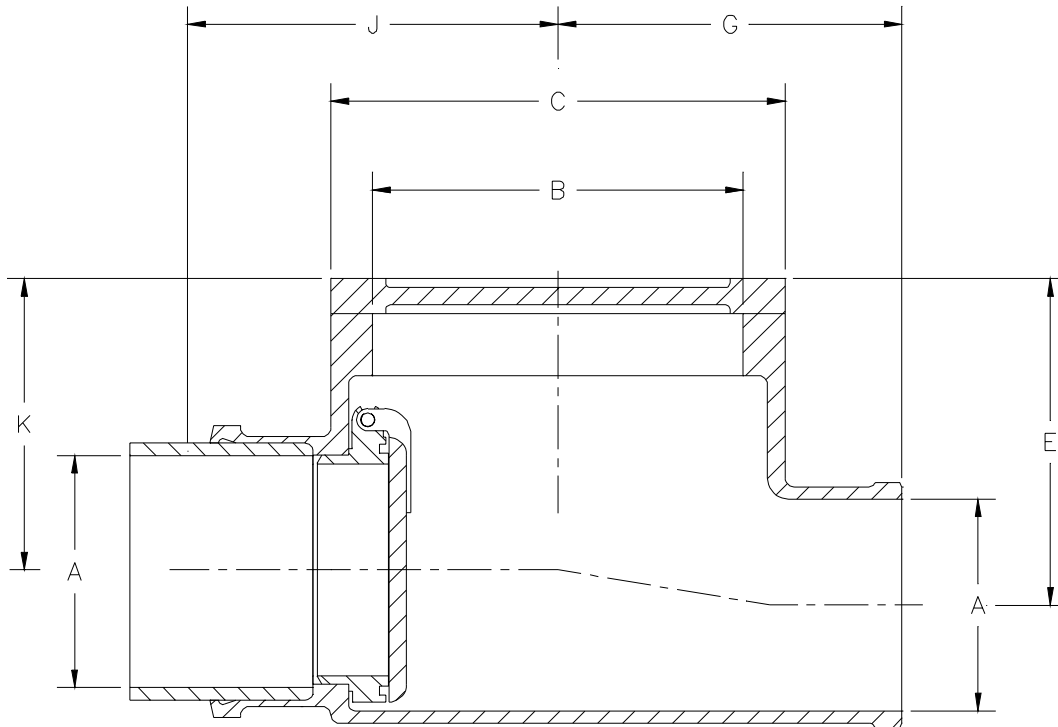

Dimensions In Inches [mm]							Approx. Wt. Lbs. [kg]
A Pipe Size	B	C	E	G	J	K	
6 [152]	8 1/4 [210]	9 1/2 [241]	6 5/8 [168]	10 [254]	7 3/4 [197]	5 1/8 [130]	57 [26]

ENGINEERING SPECIFICATION: ZURN Z-1090-76 Backwater Valve, Dura-Coated cast iron body with Hub & Spigot inlet and outlet, gasketed bolted cover, automatic type ABS valve seat and flapper which hangs closed during periods of non-operation

PREFIXES

___ Z- D.C.C.I. Body and Cover*

SUFFIXES

___ -G Galvanized Cast Iron

REV.	DATE: 6/9/95	C.N. NO. 72057
DWG. NO. P-14187 PRODUCT NO. Z-1090-76		

*REGULARLY FURNISHED UNLESS OTHERWISE SPECIFIED