



Z550-TG

9 [229] DIAMETER HEAVY-DUTY DRAIN WITH TRACTOR GRATE

SPECIFICATION SHEET

TAG _____

Dimensional Data (inches and [mm]) are Subject to Manufacturing Tolerances and Change Without Notice

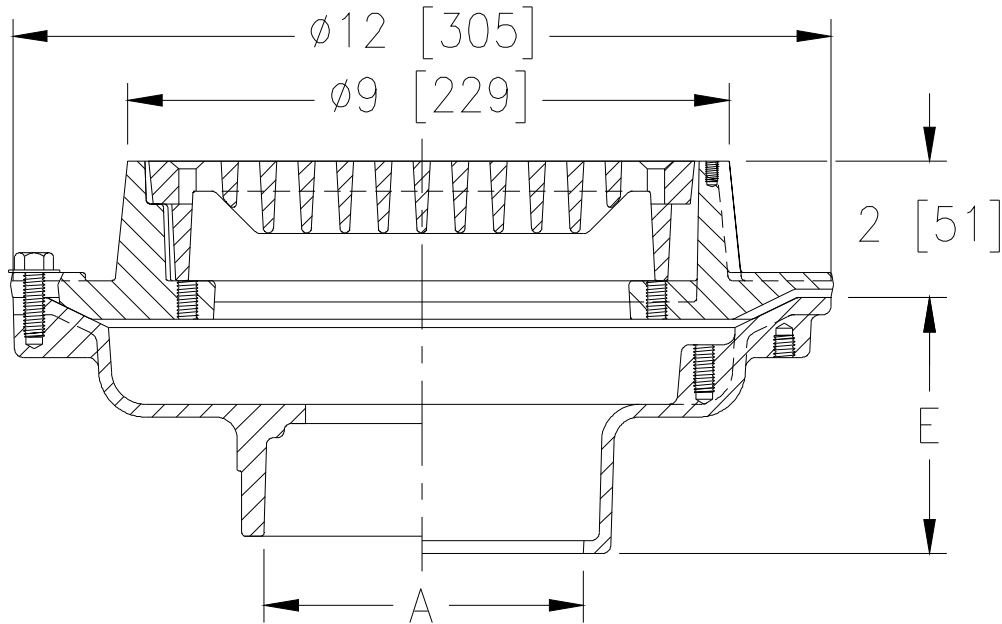

A- Pipe Size in. [mm]	Approx. Wt. Lbs. [kg]	Grate Open Area Sq. In. [cm ²]
2,3,4 [51,76,102]	28 [13]	18 [116]
6 [152]	30 [14]	

ENGINEERING SPECIFICATION: ZURN Z550-TG
 9" [229mm] Diameter top drain, Dura-Coated cast iron body with bottom outlet, seepage pan, combination membrane flashing clamp, and frame for heavy-duty, cast iron, heel-proof slotted tractor grate.

OPTIONS (Check/specify appropriate options)

PIPE SIZE

- 3,4 [76,102]
- 3,4 [76,102]
- 3,4 [76,102]
- 2,3,4 [51,76,102]
- 6 [152]
- 2,3,4 [51,76,102]

OUTLET (Specify size/type)

- _____ IC Inside Caulk
- _____ IG Inside Gasket
- _____ IP Threaded
- _____ NH No-Hub
- _____ NH No-Hub
- _____ NL Neo-Loc

'E' BODY HT. DIM.

- 3-3/4 [95]
- 3-3/4 [95]
- 2-3/4 [70]
- 4-3/4 [121]
- 5-1/4 [133]
- 3-1/2 [89]

PREFIXES

- _____ Z D.C.C.I. Body and Top*
- _____ ZB D.C.C.I. Body with Polished Bronze Top (Add 3/16 [5] to 2 [51] Dim. & 3/4 [20] to 9 [229] Dim.)
- _____ ZN D.C.C.I. Body with Polished Nickel Bronze Top (Add 3/16 [5] to 2 [51] Dim. & 3/4 [20] to 9 [229] Dim.)

SUFFIXES

- _____ -AR Acid Resisting Epoxy Coated Cast Iron
- _____ -DG Duresist Grate
- _____ -G Galvanized Cast Iron
- _____ -P Trap Primer Connection
- _____ -S Secondary Strainer
- _____ -TC Neo-Loc Test Cap Gasket (2,3,4 [51,76,102] NL Bottom Outlet Only)
- _____ -TS Top Secured with Slotted Screw
- _____ -VP Vandal-Proof Secured Top
- _____ -90 90° Threaded Side Outlet Body (3,4 [51,76] Sizes Only)

* Regularly furnished unless otherwise specified.