



Z1187-SI-115

SIZE 75 SAND INTERCEPTOR

SPECIFICATION SHEET

TAG _____

Dimensional Data (inches and [mm]) are Subject to Manufacturing Tolerances and Change Without Notice

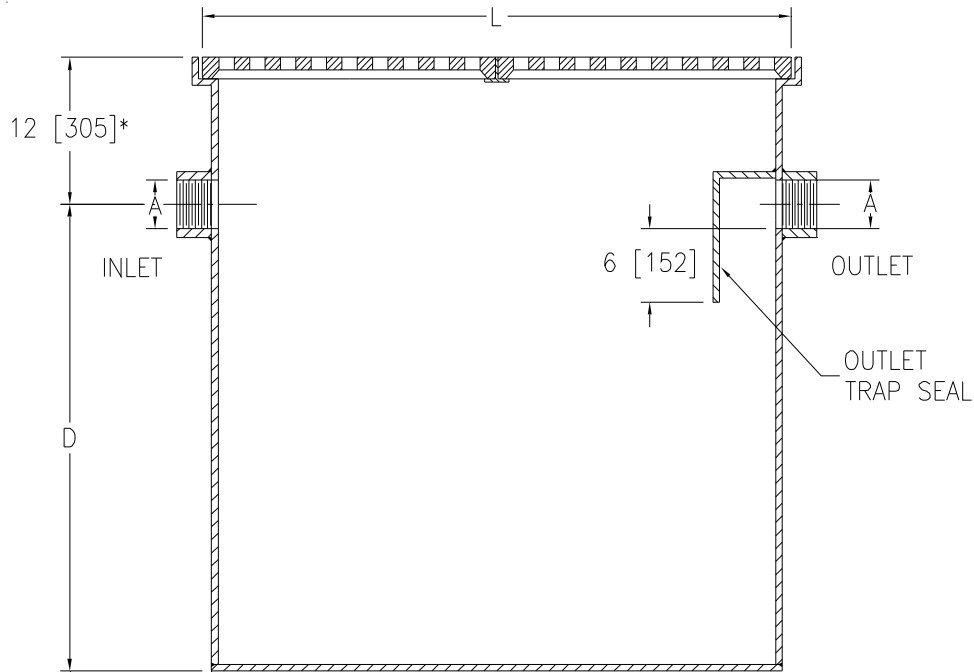

*12 [305] REGULARLY FURNISHED
SPECIFY DIMENSION IF HIGHER
OR LOWER IS REQUIRED

Size	Flow G.P.M. [L] (Max.)	A Pipe Size	L	D	Capacity Gal. [L] (Static)	No. of 12 x 24 [305 x 610] Grates	Width	Approx. Wt. Lbs. [Kg]
75	75 [284]	4 [102]	48 [1219]	38 [965]	180 [681]	4	24 [610]	260 [118]

ENGINEERING SPECIFICATION: ZURNZ1187-SI-115

Size 75 Acid Resistant Coated interior and exterior fabricated steel sand interceptor with threaded inlet and outlet, complete with removable heavy-duty grates.

OPTIONS (Check/specify appropriate options)

PREFIXES

___ Z Acid Resistant Coated Fabricated Steel*

SUFFIXES

- ___ -E Integral Extension Assembly (Specify extension height)
- ___ -DG Duresist Grate
- ___ -K Anchor Flange 1-3/4 [44] down from top and 2 [51] wide. No extension required to accommodate -K option.
- ___ -KC Anchor Flange 1-3/4 [44] down from top and 2 [51] wide with clamp collar. No extension required to accommodate -KC option.
- ___ -NH No-Hub Inlet and Outlet (Z1040)
- ___ -SC Heavy-Duty Reinforced Cover(s) rated at 10,000 lbs. [4536 Kg.] maximum safe live load.
- ___ -VP Vandal-Proof Screws

REV. -	DATE: 10/01/13	C.N. NO. 130000
PROD./DWG. NO. Z1187-SI-115		

*REGULARLY FURNISHED UNLESS OTHERWISE SPECIFIED