



Z415I-75

BODY ASSEMBLY W "TYPE I" STRAINER & DEX-O-TEX FLANGE

SPECIFICATION SHEET

TAG _____

Dimensional Data (inches and [mm]) are Subject to Manufacturing Tolerances and Change Without Notice

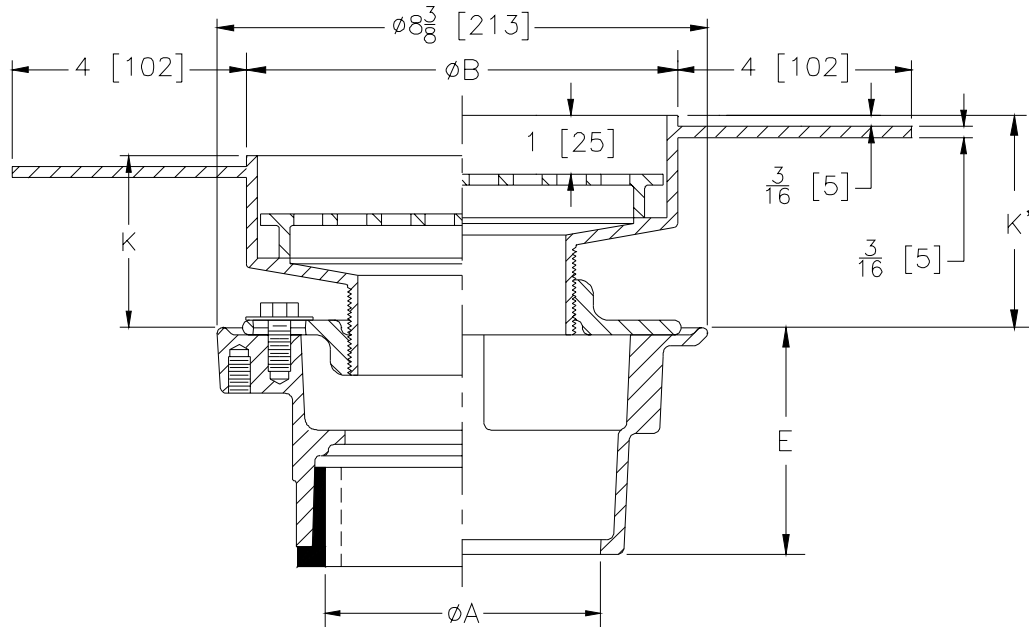

Dimensions In Inches						Approx. Wt. Lbs. [Kg.]	Strainer Open Area Sq. In. [Cm ²]
A - Pipe Size	B Strainer Dia.	K		K'			
		Min.	Max.	Min.	Max.		
2-3-4 [51-76-102]	7 [178]	2 1/4 [57]	2 3/8 [60]	3 1/8 [79]	4 1/4 [108]	19 [7]	13 [330]
3-4 [76-102]	9 [229]	2 [51]	3 [76]	2 7/8 [73]	4 [102]	23 [10]	23 [584]
6 [152]	9 [229]	2 [51]	2 1/4 [57]	2 7/8 [73]	4 [102]	23 [10]	23 [584]

ENGINEERING SPECIFICATION:
ZURN ZN415I-75 Floor and shower drain, Dura-Coated cast iron body with bottom outlet, combination invertible membrane clamp and adjustable collar with "TYPE I" polished nickel bronze strainer with raised Dex-O-Tex flange.

OPTIONS (Check/specify appropriate options)

PIPE SIZE

- 2 thru 4 [51 thru 102]
- 2 [51]
- 3 [76]
- 4 [102]
- 6 [152]
- 2 thru 4 [51 thru 102]
- 2 thru 4 [51 thru 102]

(Specify type/size) **OUTLET**

- _____ IC Inside Caulk
- _____ IP Threaded
- _____ IP Threaded
- _____ IP Threaded
- _____ IP Threaded
- _____ NH No-Hub
- _____ NL Neo-Loc

'E' BODY HT. DIMENSION

- 3 7/8 [98]
- 2 3/8 [60]
- 2 5/8 [67]
- 2 7/8 [73]
- 2 3/4 [70]
- 3 7/8 [98]
- 4 5/8 [117]

PREFIXES

- _____ **ZB** D.C.C.I. Body Assembly with Polished Bronze Top
- _____ **ZN** D.C.C.I. Body Assembly with Polished Nickel Bronze Top*

SUFFIXES

- _____ **-AR** Acid Resisting Epoxy Coated Cast Iron
- _____ **-G** Galvanized Cast Iron
- _____ **-P** Primer Connection (Specify 1/2 [13] or 3/4 [19])
- _____ **-TC** Neo-loc Test Cap Gasket (2 - 4 [50 - 100] NL Bottom Outlet Only)
- _____ **-TS** Top Secured with slotted Screws
- _____ **-U** 1 - 3 [25 - 76] High Extension Adapter
- _____ **-V** Backwater Valve
- _____ **-Y** Sediment Bucket
- _____ **-90** 90° Side Outlet Body (2 [51], 3 [76] Only)

*REGULARLY FURNISHED UNLESS OTHERWISE SPECIFIED

REV. A	DATE: 03/11/04	C.N. NO. 92015
DWG. NO. P-13907	PRODUCT NO. Z415I-75	