



Z1187-SI-100

SIZE 20 SAND INTERCEPTOR WITH INTEGRAL EXTENSION

SPECIFICATION SHEET

TAG _____

Dimensional Data (inches and [mm]) are Subject to Manufacturing Tolerances and Change Without Notice

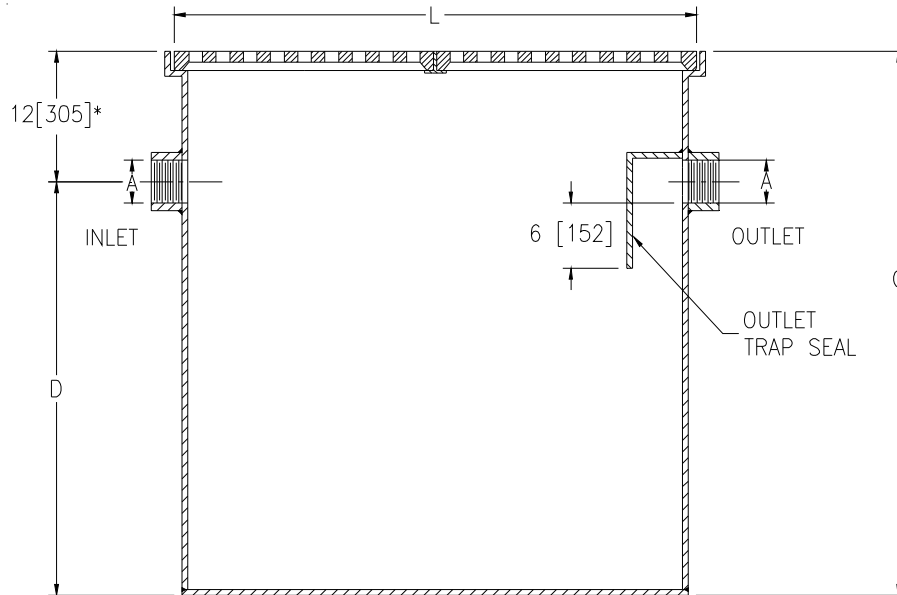

*12[305] REGULARLY FURNISHED—
SPECIFY DIMENSION IF HIGHER
OR LOWER IS REQUIRED

Extension Designation -E	Size	Flow G.P.M. [L] (Max.)	A Pipe Size	C	L	D	Capacity Gal. [L] (Static)	No. of 12x24 [305x610] Grates	Width
E 16	20	20 [76]	4 [102]	54 [1372]	24 [610]	26 [660]	60 [227]	2	24 [610]

ENGINEERING SPECIFICATION: ZURN Z1187-SI-100

Acid Resistant Coated interior and exterior fabricated steel sand interceptor with threaded inlet and outlet, integral extension, complete with removable heavy-duty grates.

OPTIONS (Check/specify appropriate options)

PREFIXES

___ Z Acid Resistant Coated Fabricated Steel*

SUFFIXES

- ___ -DG Duresist Grate
- ___ -NH No-Hub Inlet and Outlet (Specify Size)
- ___ -SC Extra-Heavy-Duty Reinforced Cover(s) for vehicular traffic. (Specify working load requirements)
- ___ -VP Vandal-Proof Screws

REV.	DATE: 03/17/10	C.N. NO. 110860
DWG. NO. P-15870 PRODUCT NO. Z1187-SI-100		

*REGULARLY FURNISHED UNLESS OTHERWISE SPECIFIED