



Z415B-V-90

LATERAL FLOOR AND SHOWER DRAIN W/ "TYPE B"
STRAINER AND BACKWATER VALVE AND SIDE OUTLET

SPECIFICATION SHEET

TAG _____

Dimensional Data (inches and [mm]) are Subject to Manufacturing Tolerances and Change Without Notice

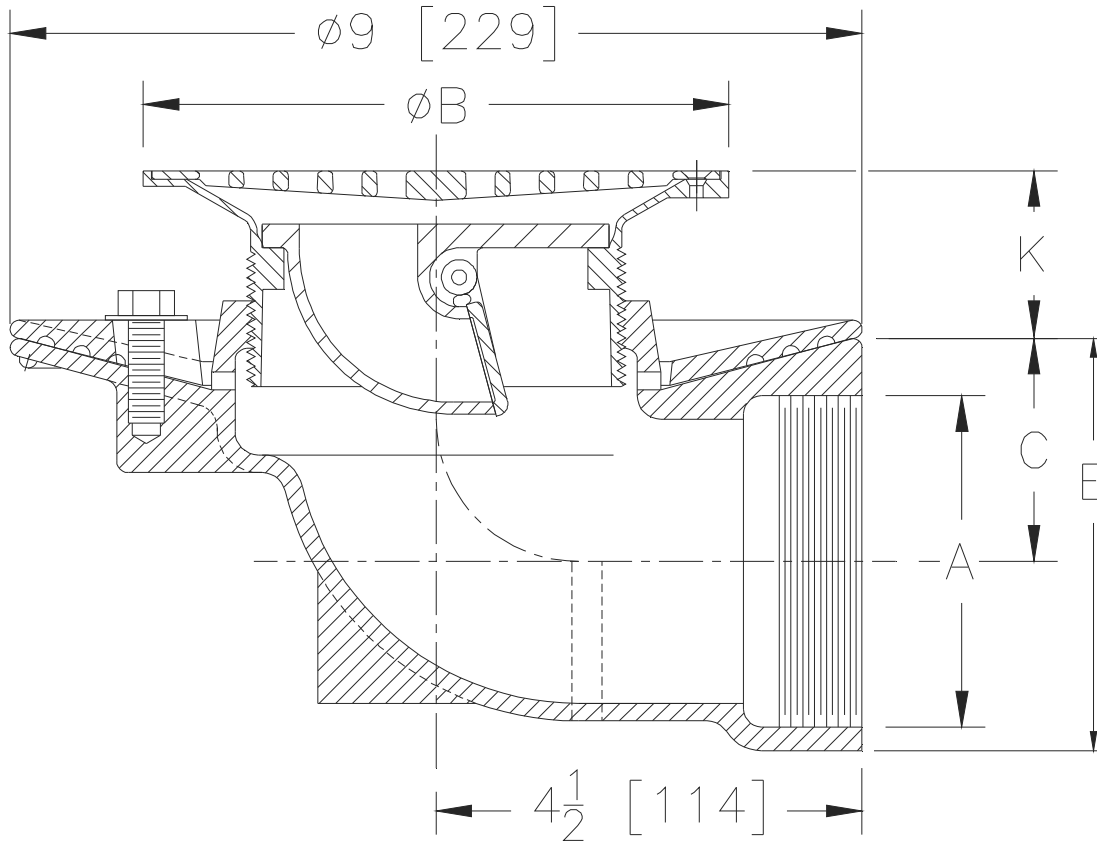

Dimensions in In [mm]				Approx Wt. lbs [kg]	Strainer Open Area in ² [cm ²]
A Pipe Size	B Strainer Dia.	K			
		Min	Max		
2,3 [51,76]	5 [127]	1/2 [13]	1-5/8 [41]	19 [9]	8 [52]
2,3 [51,76]	6 [152]	3/4 [19]	1-3/4 [44]	23 [10]	9 [58]

ENGINEERING SPECIFICATION: ZURN ZN415B-V-90
Floor and shower drain, Dura-Coated cast iron body with side outlet, adjustable "TYPE B" polished nickel bronze strainer and backwater valve.

OPTIONS (Check/specify appropriate options)

PIPE SIZE

2 [51]

3 [76]

OUTLET (Specify size/type)

_____ IP Threaded

_____ IP Threaded

'C' DIM.

3-5/16 [84]

2-3/4 [70]

E BODY HT. DIM.

4-3/8 [111]

4-3/8 [111]

PREFIXES

_____ ZB D.C.C.I. Body with Polished Bronze Top

_____ ZN D.C.C.I. Body with Polished Nickel Bronze Top*

SUFFIXES

_____ -AR Acid Resistant Epoxy Coated Cast Iron

_____ -CP Chrome-Plated Bronze Top

_____ -G Galvanized Cast Iron

_____ -OF Oval Funnel (6 [152] Strainer Only)

_____ -PC Protective Cover

_____ -U 1-3 [25-76] High Extension Adapter

_____ -VP Vandal Proof Secured Top

_____ -4 4 [102] Diameter Funnel

* Regularly furnished unless otherwise specified.