

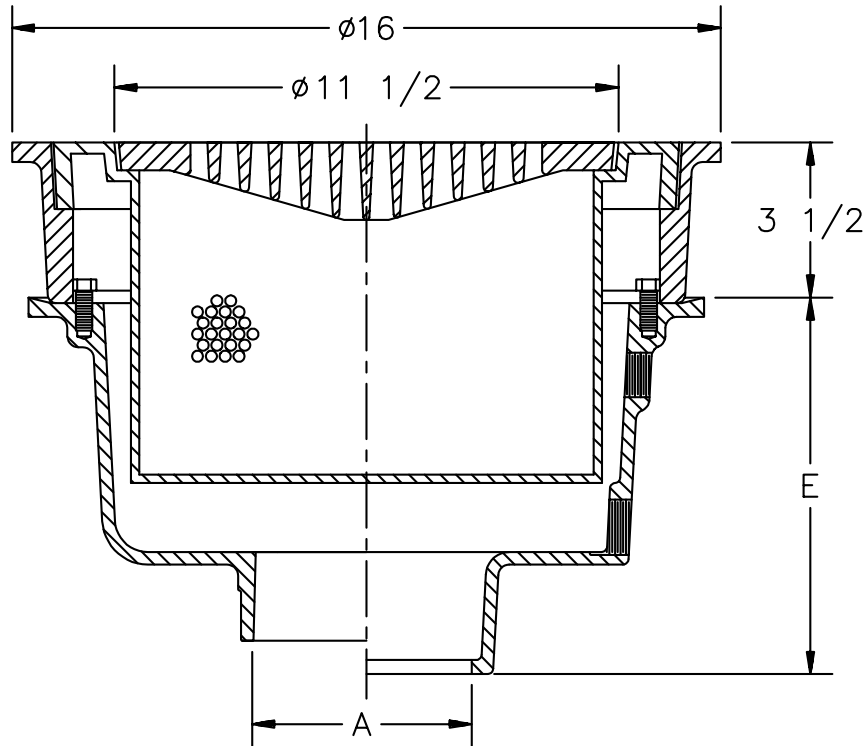

Z-543-78
16" DIAMETER SUR-SET HEAVY
DUTY DRAIN

TAG: _____

Dimensional Data (inches and [mm]) are Subject to Manufacturing Tolerances and Change Without Notice



A- Pipe Size In.	Approx. Wt. Lbs.	Grate Open Area Sq. In.
3-4-5-6	135	45

ENGINEERING SPECIFICATION: ZURN Z-543-78 16" Sur-Set Heavy Duty Diameter drain, Dura-Coated cast iron deep sump body with bottom outlet, seepage pan and combination membrane flashing clamp and frame for sur-set heavy duty cast iron slotted grate with suspended sediment bucket.

OPTIONS (Check/specify appropriate options)

OUTLET (Specify type)

- _____ **IC** Inside Caulk
- _____ **IG** Inside Caulk w/Sealtrol Gskt.
- _____ **IP** Threaded
- _____ **NH** No-Hub
- _____ **NL** Neo-Loc

PIPE SIZE (Specify size)

- _____ 3" thru 6"
- _____ 3",4",6"
- _____ 3" thru 6"
- _____ 3" thru 6"
- _____ 3",4"

'E' BODY HT. DIMENSION

- 8-1/2"
- 8-1/2"
- 7"
- 8-1/2"
- 7-3/4"

PREFIXES

- _____ **Z-** D.C.C.I. Body and Grate*
- _____ **ZB-** D.C.C.I. Body with Polished Bronze Grate (Add 3/16" to 3-1/2" Dim.)
- _____ **ZN-** D.C.C.I. Body with Polished Nickel Bronze Grate (Add 3/16" to 3-1/2" Dim.)

SUFFIXES

- _____ **-DG** Duresist Grate
- _____ **-G** Galvanized Cast Iron
- _____ **-V** Backwater Valve (See Z-1099)
- _____ **-90** 90° Threaded Side Outlet (See Z-1042)

REV.	DATE: 4/29/92	C.N. NO. 68268
DWG. NO. P-13693		PRODUCT NO. Z-543-78

*REGULARLY FURNISHED UNLESS OTHERWISE SPECIFIED