



# Z1187-SI-112

## STAINLESS STEEL SAND INTERCEPTOR WITH LIGHT DUTY SOLID S.S. COVER

SPECIFICATION SHEET

TAG \_\_\_\_\_

Dimensional Data (inches and [ mm ]) are Subject to Manufacturing Tolerances and Change Without Notice

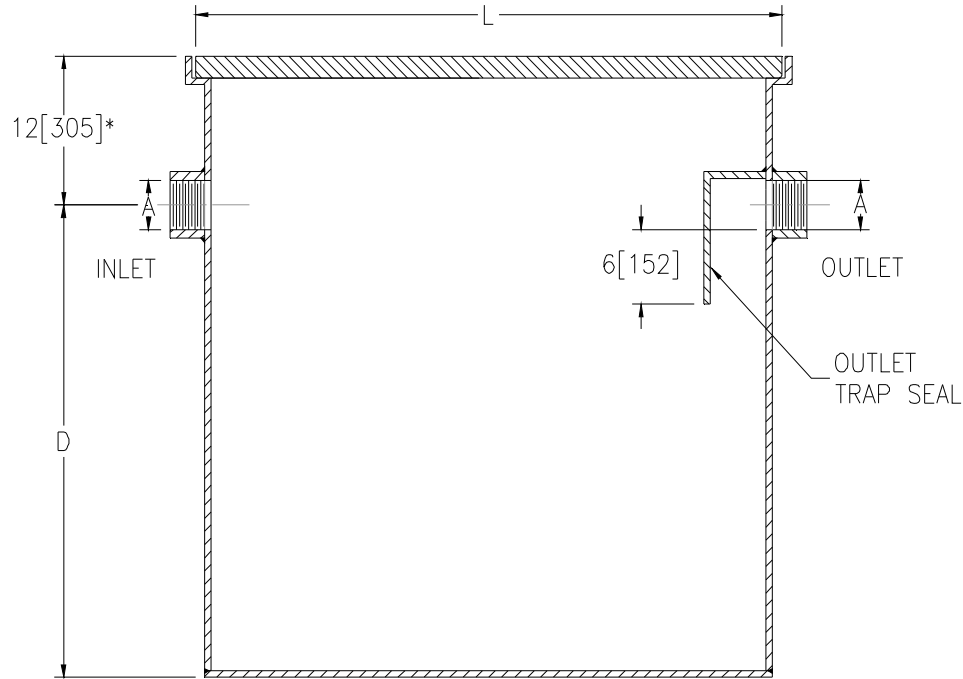

\*12[305] REGULARLY FURNISHED—  
SPECIFY DIMENSION IF HIGHER  
OR LOWER IS REQUIRED

Size	Flow G.P.M. [L] (Max.)	A Pipe Size	L	D	Capacity Gal. [L] (Static)	No. of 12 x 24 [305 x 610] Grates	Width	Approx. Wt. Lbs. [Kg]
20	20 [76]	4 [102]	24 [610]	26 [660]	60 [227]	2	24 [610]	133 [60]
50	50 [189]	4 [102]	48 [1219]	26 [660]	120 [454]	4	24 [610]	204 [92]
150	150 [568]	4 [102]	48 [1219]	38 [965]	360 [1363]	8	48 [1219]	368 [167]
250	250 [946]	6 [152]	72 [1829]	39 [991]	540 [2044]	12	48 [1219]	1294 [587]
500	500 [1893]	6 [152]	120 [3058]	51 [1295]	1200 [4542]	20	48 [1219]	2204 [1000]

**ENGINEERING SPECIFICATION:** ZURN Z1187-SI-112

Fabricated Stainless Steel sand interceptor with threaded inlet and outlet, complete with removable S.S light duty solid cover. Stainless Steel conforms to ASTM specifications A351 grade CF8 (Type 304).

**OPTIONS** (Check/specify appropriate options)

**PREFIXES**

\_\_\_ Z Type 304 Fabricated Stainless Steel\*

**SUFFIXES**

\_\_\_ -E Integral Extension Assembly (Specify extension height)  
\_\_\_ -VP Vandal-Proof Screws

REV.	DATE: 08/02/12	C.N. NO. 124623
DWG. NO. 310227	PRODUCT NO. Z1187-SI-112	

\*REGULARLY FURNISHED UNLESS OTHERWISE SPECIFIED