



# Z1731-TS

FLOOR DRAIN MEDIUM DEPTH W/ SECURED TOP

SPECIFICATION SHEET

TAG \_\_\_\_\_

Dimensional Data (inches and [ mm ]) are Subject to Manufacturing Tolerances and Change Without Notice

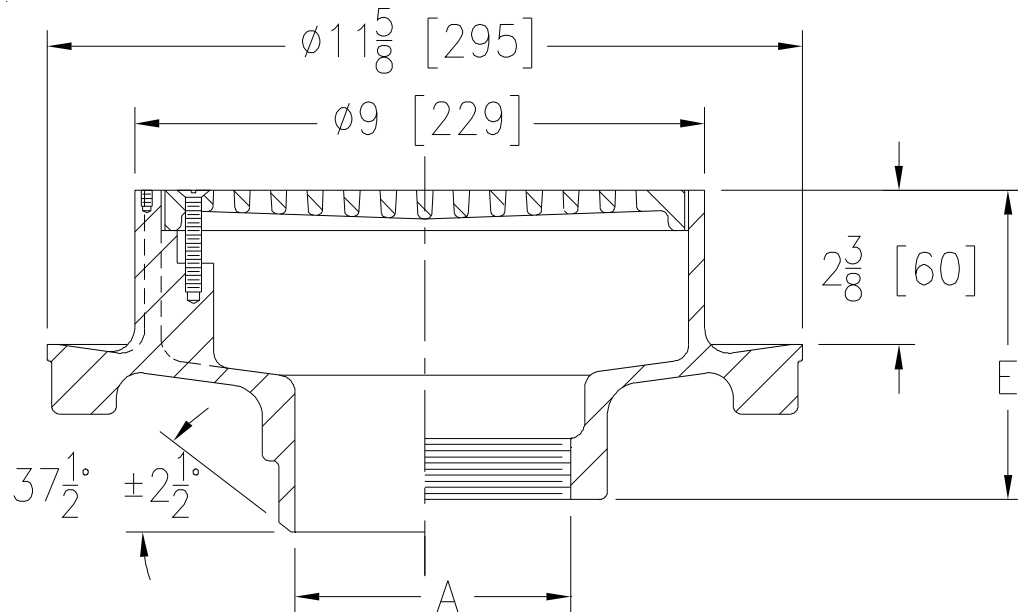

A - Pipe Size In [mm]	Approx. Wt. Lbs. [kg]	Grate Open Area Sq. In. [cm <sup>2</sup> ]
3,4 [76,102]	22 [10]	21 [135]

**ENGINEERING SPECIFICATION: ZURN Z1731-TS**

9" [229mm] Diameter all Type 304 (CF8) stainless steel heavy-duty floor drain with integral anchor flange, and secured grate with plain finish.

**OPTIONS** (Check/specify appropriate options)

**PIPE SIZE**

3,4 [76,102]

3,4 [76,102]

3,4 [76,102]

3,4 [76,102]

(Specify size/type) **OUTLET**

\_\_\_ BW Butt-weld

(Specify Schedule 10 or 40)

\_\_\_ IC Inside Caulk

\_\_\_ IP Threaded

\_\_\_ NH No-Hub

**'E' BODY HT. DIM.**

5-11/16 [144]

5-11/16 [144]

5-11/16 [144]

5-11/16 [144]

**PREFIXES**

\_\_\_ Z Type 304 (CF8) Stainless Steel Body\*

\_\_\_ ZM Type 316 (CF8M) Stainless Steel Body

**SUFFIXES**

\_\_\_ -K Seepage Holes Only

\_\_\_ -KC Clamp Collar with Seepage Holes

\_\_\_ -Y Sediment Bucket

\* Regularly furnished unless otherwise specified.