



Z1751-152

12 X 12 [305 X 305] SANI-FLOR RECEPTOR 8 [203] SUMP
DEPTH W/ SEDIMENT BUCKET & 6 [152] THREADED
CONNECTION

SPECIFICATION SHEET

TAG _____

Dimensional Data (inches and [mm]) are Subject to Manufacturing Tolerances and Change Without Notice

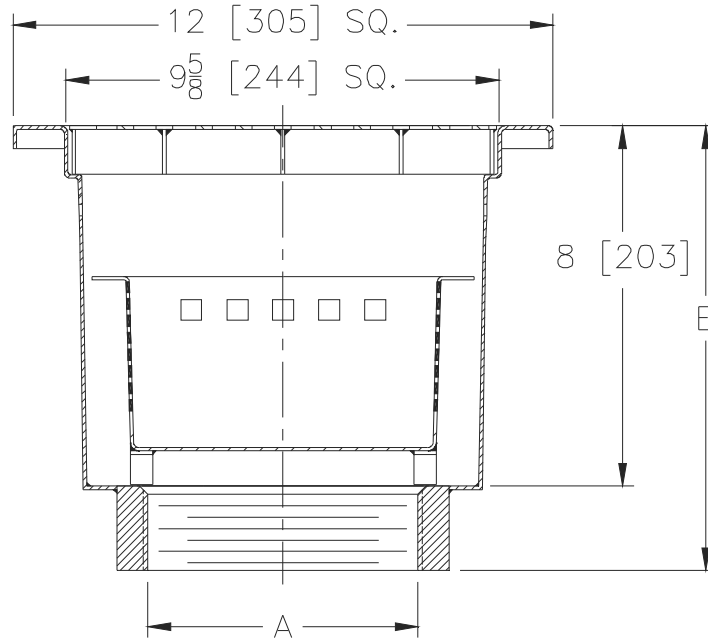

A- Pipe Size In [mm]	Approx. Wt. Lbs. [kg]	Grate Open Area Sq. In. [cm ²]
6 [152]	21 [9]	23 [148]

ENGINEERING SPECIFICATION: ZURN Z1751-152

12" x 12" x 8" [305mm x 305mm x 203mm] deep, 16 gage, All Type 304 (CF8) Stainless Steel light duty Sani-Flor receptor with non-tilt, loose set full grate with 1/2" [13mm] square openings and sediment bucket.

OPTIONS (Check/specify appropriate options)

PIPE SIZE

6 [152]

(Specify size/type) **OUTLET**

_____ IP Threaded

'E' BODY HT. DIM.

9-7/8 [251]

PREFIXES

- _____ Z Type 304 (CF8) Stainless Steel Body*
- _____ ZM Type 316 (CF8M) Stainless Steel

SUFFIXES

- | | |
|--|--|
| _____ -DX Dex-o-tex Flange | _____ -4 Full Grate w/ 3 [76] Square Center Opening |
| _____ -HD Extra Heavy-Duty Grate | _____ -5 Grate w/ 4 [102] Dia. x 3-3/4 [95] High |
| _____ -HP Heel-Proof Grate | _____ Type 304 Stainless Steel Funnel |
| _____ -K Anchor Flange w/ Seepage Holes | _____ -8 Grate w/ 9 [229] Dia. x 3-1/2 [90] High |
| _____ -KC Anchor Flange w/ Seepage Holes and Clamp Collar | _____ Type 304 Stainless Steel Oval Funnel |
| _____ -LSH (Less) Seepage Holes | _____ -15 Solid Cover |
| _____ -P 1/2 [13] Trap Primer Connection | _____ -16 1/2 Solid Cover |
| _____ -SG Solid Gasketed Cover | _____ -17 3/4 Solid Cover |
| _____ -VP Vandal-Proof Secured Top | _____ -18 Solid Cover w/ 3 [76] Square Center Opening |
| _____ -1 (Less) Grate | _____ -19 Full Hinged Grate |
| _____ -2 1/2 Grate | _____ -20 Full Hinged Solid Cover |
| _____ -3 3/4 Grate | |

* Regularly furnished unless otherwise specified.