



**Z1187-SI-138**  
**SIZE 145 SAND INTERCEPTOR**

**SPECIFICATION SHEET**

**TAG** \_\_\_\_\_

Dimensional Data (inches and [ mm ]) are Subject to Manufacturing Tolerances and Change Without Notice

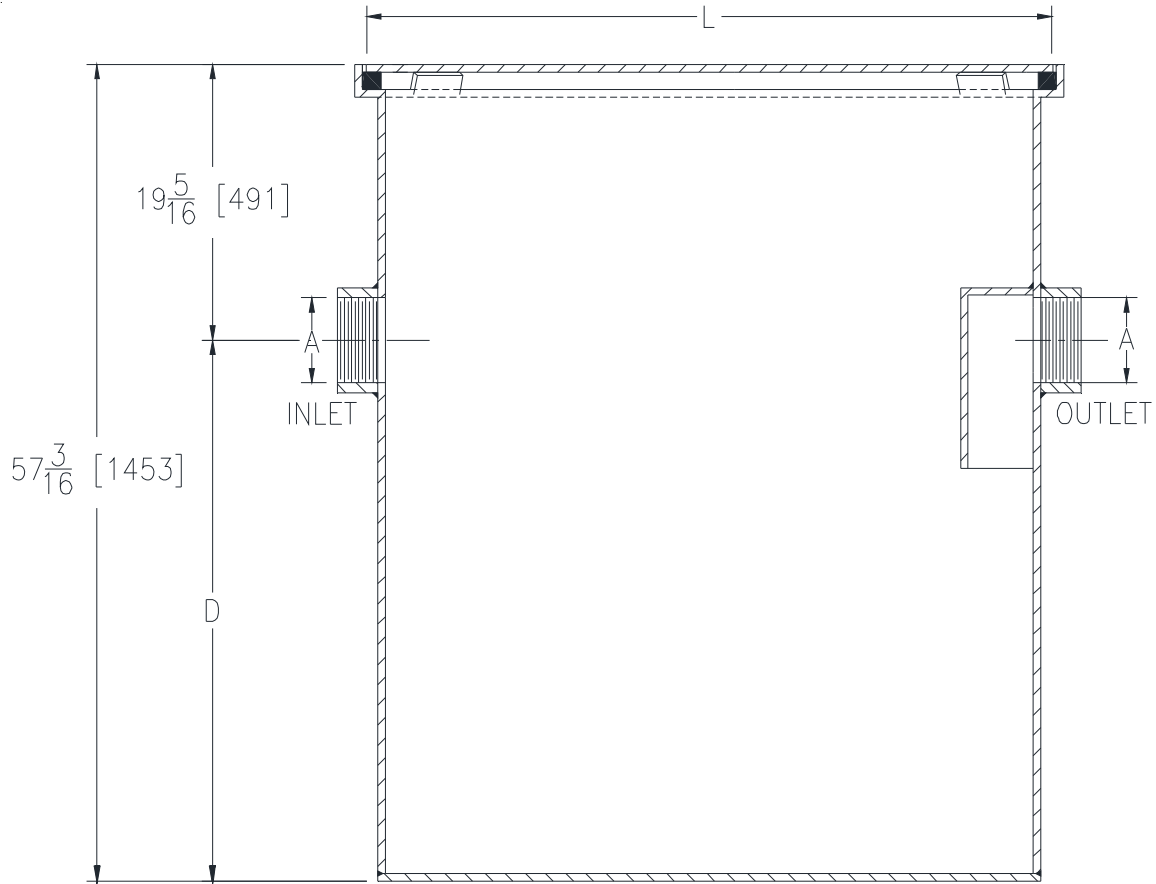

Size	Flow GPM [LPM] (Max.)	A - Pipe Size	L	D	Capacity Gal. [L] (Static)	Width
145	145 [549]	6 [152]	48 [1219]	37-15/16 [963]	348 [1321]	48 [1219]

**ENGINEERING SPECIFICATION: ZURN Z1187-SI-138**

Acid Resistant Coated interior and exterior fabricated steel sand interceptor with threaded inlet and outlet, complete with secured, gasketed, non-skid cover.

**OPTIONS** (Check/specify appropriate options)

**PREFIXES**

\_\_\_ Z Acid Resistant Coated Fabricated Steel\*

**SUFFIXES**

- \_\_\_ -E 6 [152] Integral Extension Assembly for Recessed Installation
- \_\_\_ -NH No-Hub Inlet and Outlet (Specify Size)
- \_\_\_ -VP Vandal Proof Screws

\* Regularly furnished unless otherwise specified.