



# Z1749-76

## 7 1/8 DIA. [181] SANI-FLOR RECEPTOR 4 1/2 [114] SUMP DEPTH

SPECIFICATION SHEET

TAG \_\_\_\_\_

Dimensional Data (inches and [ mm ]) are Subject to Manufacturing Tolerances and Change Without Notice

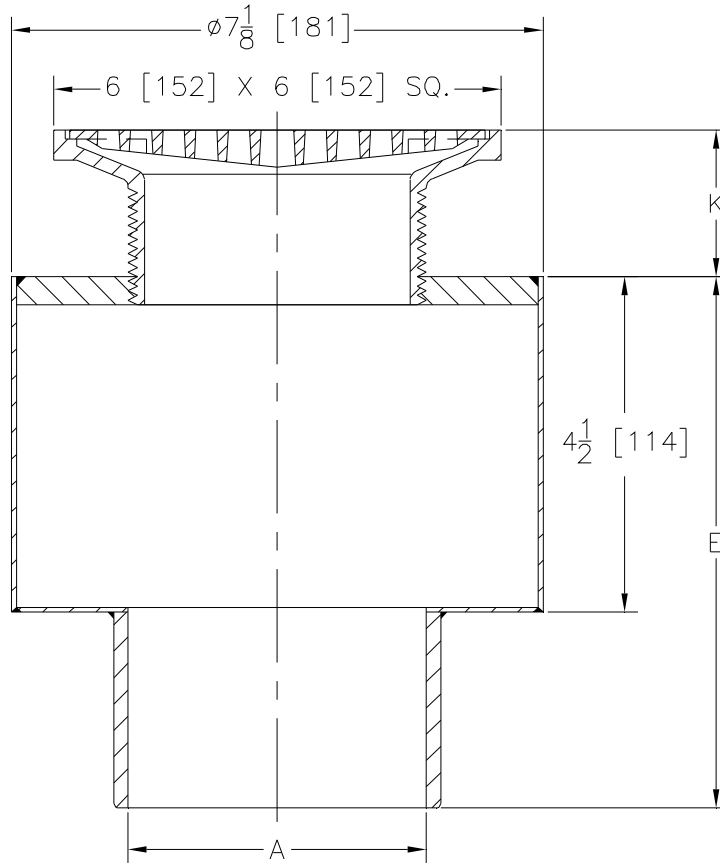

A- Pipe Size In.	K		Approx. Wt. Lbs. [kg]	Grate Open Area Sq. In. [cm <sup>2</sup> ]
3-4 [76-102]	7/8 [22]	2 [51]	15 [7]	13 [84]

**ENGINEERING SPECIFICATION:** ZURN Z1749-76  
7 1/8 dia. x 4 1/2 [181 x 114] deep, 14 gage, All Type 304 (CF8) Stainless Steel light duty Sani-Flor receptor with "TYPE S" square adjustable strainer top with secured heel-proof medium duty grate.

**OPTIONS** (Check/specify appropriate options)

**PIPE SIZE**

3 and 4 [76 and 102]

(Specify size/type) **OUTLET**

\_\_\_\_ NH No-Hub

**'E' BODY HT. DIM.**

7 1/8 [181]

**PREFIXES**

- \_\_\_\_ Z Type 304 (CF8) Stainless Steel Body\*
- \_\_\_\_ ZM Type 316 (CF8M) Stainless Steel

**SUFFIXES**

- \_\_\_\_ -K Anchor Flange
- \_\_\_\_ -KC Anchor Flange w/ Seepage Holes and Clamp Collar
- \_\_\_\_ -LSH (Less) Seepage Holes
- \_\_\_\_ -P 1/2 [13] Trap Primer Connection
- \_\_\_\_ -VP Vandal-Proof Secured Top
- \_\_\_\_ -Y Sediment Bucket

<b>REV. A</b>	<b>DATE: 6/7/07</b>	<b>C.N. NO. 96727</b>
<b>DWG. NO. P-15435 PRODUCT NO. Z1749-76</b>		

\*REGULARLY FURNISHED UNLESS OTHERWISE SPECIFIED