



TYPICAL INSTALLATION

Z-537-C

PARKING DECK DRAIN

Dimensional Data (inches and [mm]) are Subject to Manufacturing Tolerances and Change Without Notice

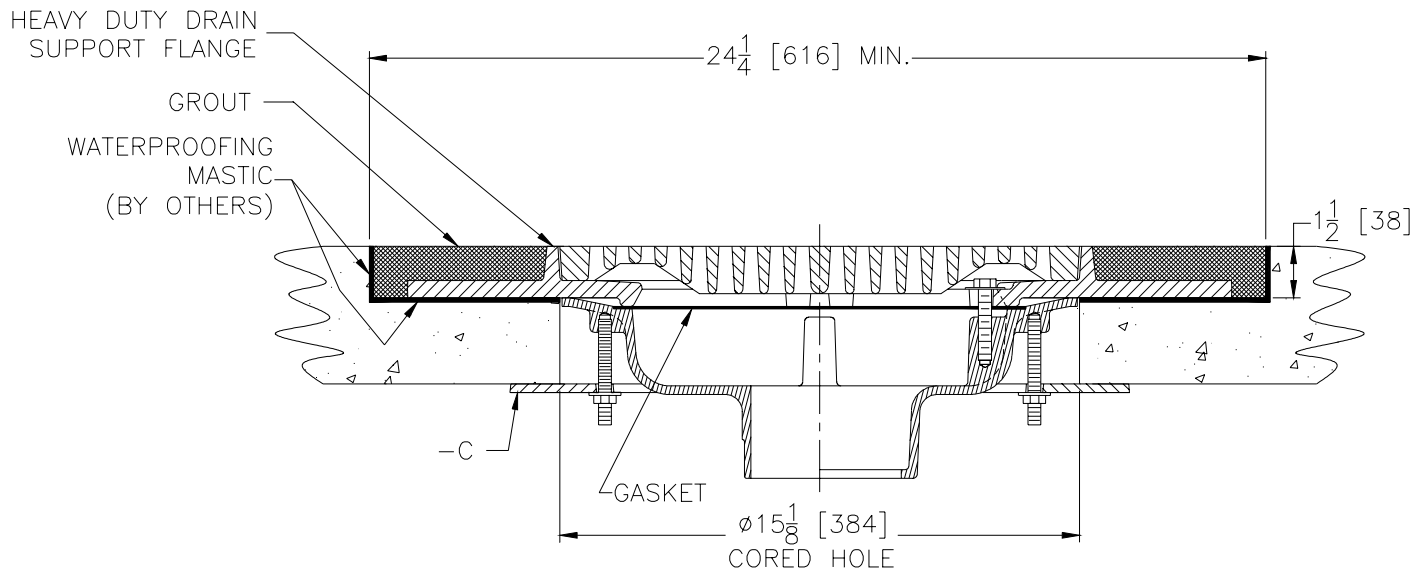

Z-537-C PARKING DECK DRAIN

Parking Deck Drains are designed for economical installation in precast construction. Wide heavy-duty flange allows shallow core drilling or boxing out and maximum strength at load bearing surface. Heavy-duty non-tilt grate is standard and underdeck clamp (-C) is available to securely fasten drain body to deck from underside. For other available parking deck drains see Z-533, Z-534, Z-535, 535-E, Z-536, and Z-536-24.

Form # FD40

Date: 12/20/01

C.N. No. 88223

Rev.