



Z1740-SP-SV

BACKWATER VALVE WITH STAINLESS STEEL
THREADED COVER AND STAINLESS STEEL
BACKWATER VALVE

SPECIFICATION SHEET

TAG _____

Dimensional Data (inches and [mm]) are Subject to Manufacturing Tolerances and Change Without Notice

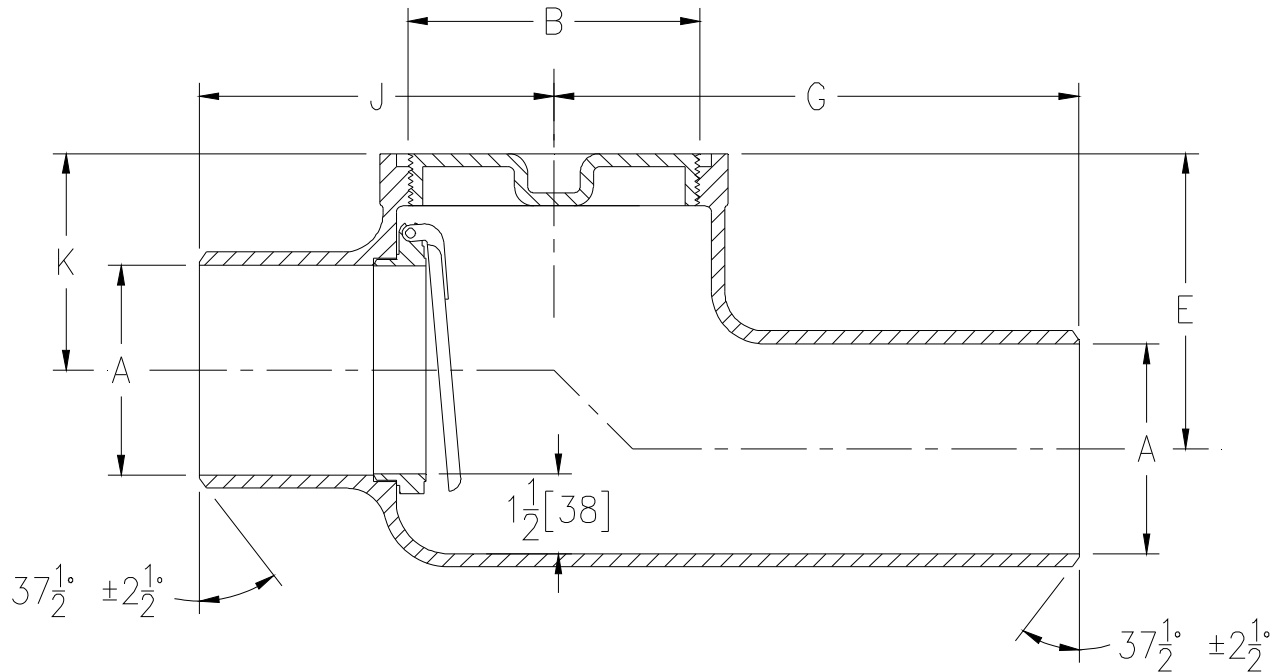

Dimensions in Inches [mm]						Approx. Wt. Lbs. [kg]
A Pipe Size	B	E	G	J	K	
4 [102]	5 [127]	5-5/8 [130]	8-1/2 [216]	6-3/4 [171]	4-1/8 [105]	40 [18]

ENGINEERING SPECIFICATION: ZURN Z1740-SP-SV

Backwater valve, Type 304 (CF8) stainless steel body with stainless steel backwater valve and stainless steel threaded cover.

OPTIONS (Check/specify appropriate options)

PIPE SIZE

4 [102]

(Specify size) **OUTLET**

_____ BW Butt-weld
(Specify Schedule 10 or 40)

PREFIXES

- _____ Z Type 304 (CF8) Stainless Steel Body*
- _____ ZM Type 316 (CF8M) Stainless Steel Body

* Regularly furnished unless otherwise specified.