



# Z1187-SI-118

## SAND INTERCEPTOR WITH INTEGRAL EXTENSION, SOLID COVERS, AND ANCHOR FLANGE W/ CLAMP COLLAR

SPECIFICATION SHEET

TAG \_\_\_\_\_

Dimensional Data (inches and [ mm ]) are Subject to Manufacturing Tolerances and Change Without Notice

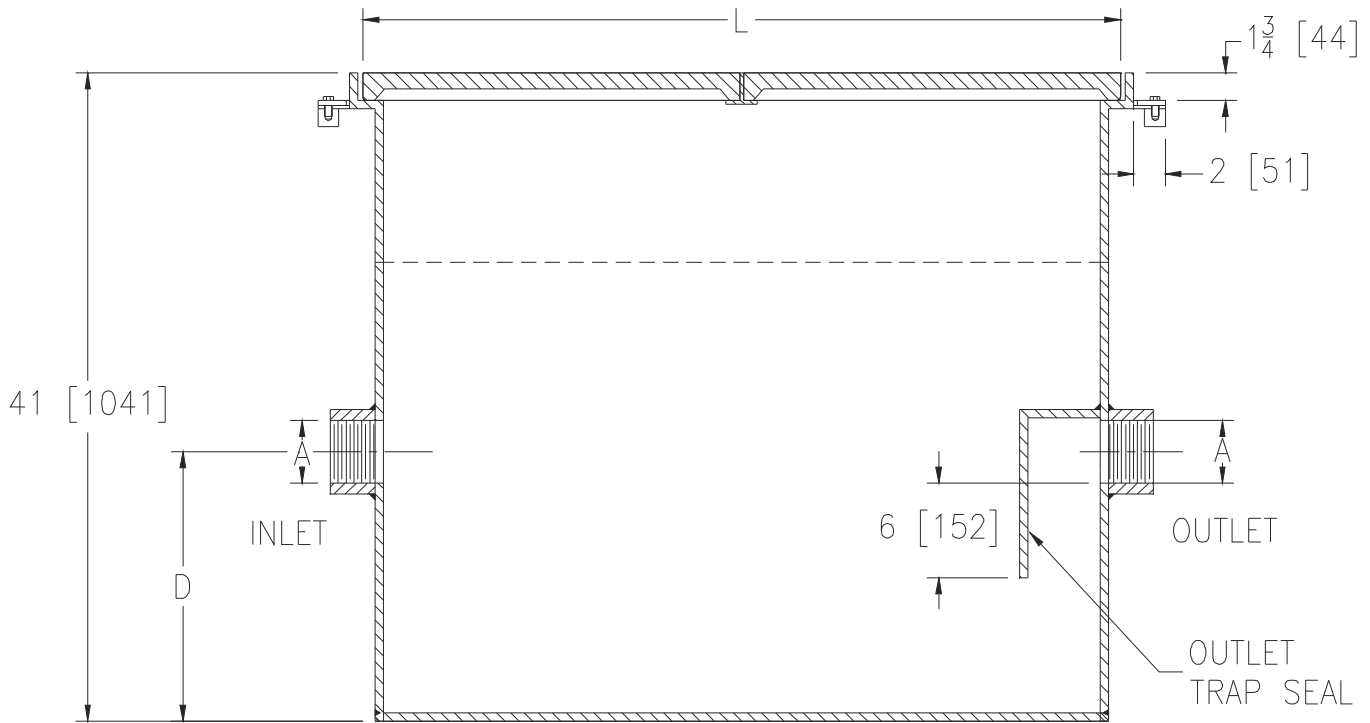

\*\*SPECIFY EXTENSION HEIGHT REQUIRED

Size	Flow G.P.M. [L] (Max.)	A Pipe Size	L	D	Capacity Gal. [L] (Static)	No. of 12 x 24 [305 x 610] Covers	Width	Approx. Wt. Lbs. [Kg] +
20	20 [76]	4 [102]	24 [610]	22 [558]	50 [189]	2	24 [610]	133 [60]

### ENGINEERING SPECIFICATION: ZURN Z1187-SI-118

Acid Resistant Coated interior and exterior fabricated steel sand interceptor with integral extension, anchor flange and clamp collar, threaded inlet and outlet, complete with removable heavy-duty solid covers rated at 10,000 lbs [4536 kg] maximum safe live load.

### OPTIONS (Check/specify appropriate options)

#### PREFIXES

\_\_\_ Z Acid Resistant Coated Fabricated Steel\*

#### SUFFIXES

\_\_\_ -NH No-Hub Inlet and Outlet (Specify Size)

+ Weight listed reflects interceptor less extension.

\* Regularly furnished unless otherwise specified.