



Z1090-77

BACKWATER VALVE FLAPPER TYPE W/ ACCESS HOUSING

SPECIFICATION SHEET

TAG _____

Dimensional Data (inches and [mm]) are Subject to Manufacturing Tolerances and Change Without Notice

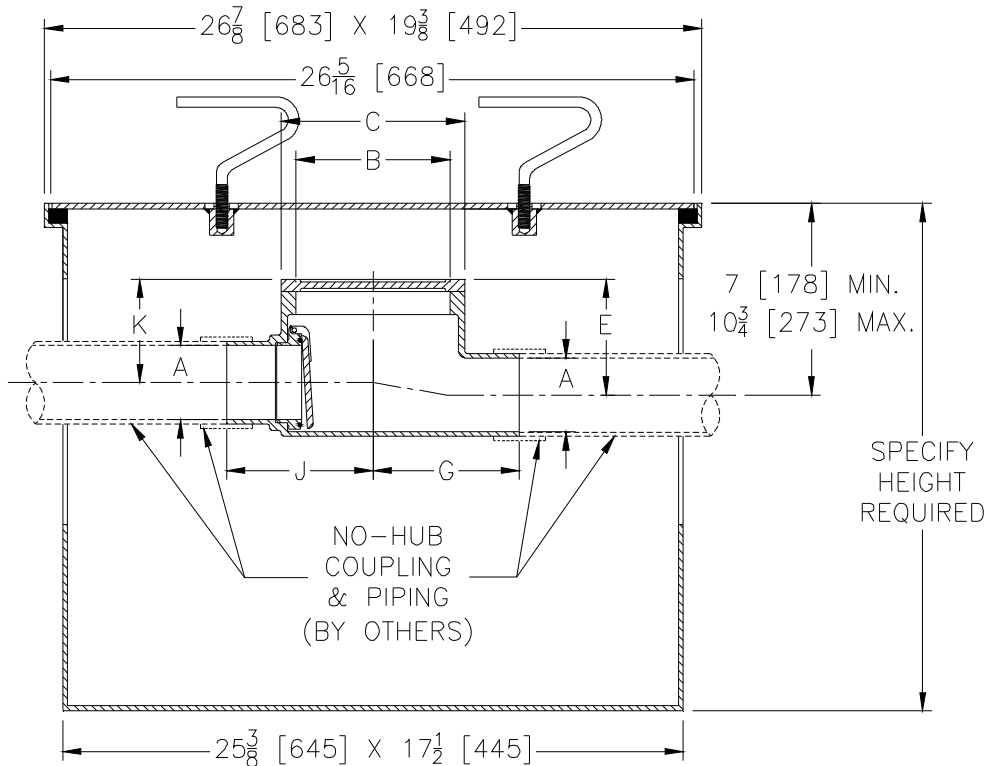

Dimensions In Inches							Approx. Wt. Lbs. Kg.
A Pipe Size	B	C	E	G	J	K	
2 [51]	5 1/4 [133]	6 1/2 [165]	4 5/8 [117]	4 7/8 [124]	5 1/4 [133]	3 5/8 [92]	16 [7]
3 [76]			4 1/8 [105]				17 [8]
4 [102]	6 3/8 [162]	7 1/2 [190]	4 3/4 [121]	6 [152]	6 [152]	4 1/4 [108]	22 [10]

ENGINEERING SPECIFICATION: ZURN Z1090-77

Backwater Valve, Dura-Coated cast iron body with No-Hub inlet and outlet, gasketed bolted cover, automatic type ABS valve seat and flapper which hangs slightly open during periods of non-operation. Complete with acid resistant epoxy coated steel access housing, gasketed non-skid cover and removable lift handles.

CONNECTIONS (Check/specify appropriate options)

PIPE SIZE _____ (Specify size) **CONNECTION** _____
 2 thru 4 [51 thru 102] _____ NH No-Hub

PREFIXES
 _____ Z D.C.C.I. Body*

SUFFIXES
 _____ -BP Bronze Threaded Plug Cover
 _____ -BV Bronze Flapper Valve (3 and 4 [76 and 102] Size)
 _____ -G Galvanized Cast Iron
 _____ -K Anchor Flange (A minimum 3 [76] extension height is required when specified)

REV. A	DATE: 03/07/13	C.N. NO. 128906
PROD. NO./DWG. NO. Z1090-77		

*REGULARLY FURNISHED UNLESS OTHERWISE SPECIFIED