



Z319-78 THOROFLUSH DRAIN LARGE CAPACITY

SPECIFICATION SHEET

TAG _____

Dimensional Data (inches and [mm]) are Subject to Manufacturing Tolerances and Change Without Notice

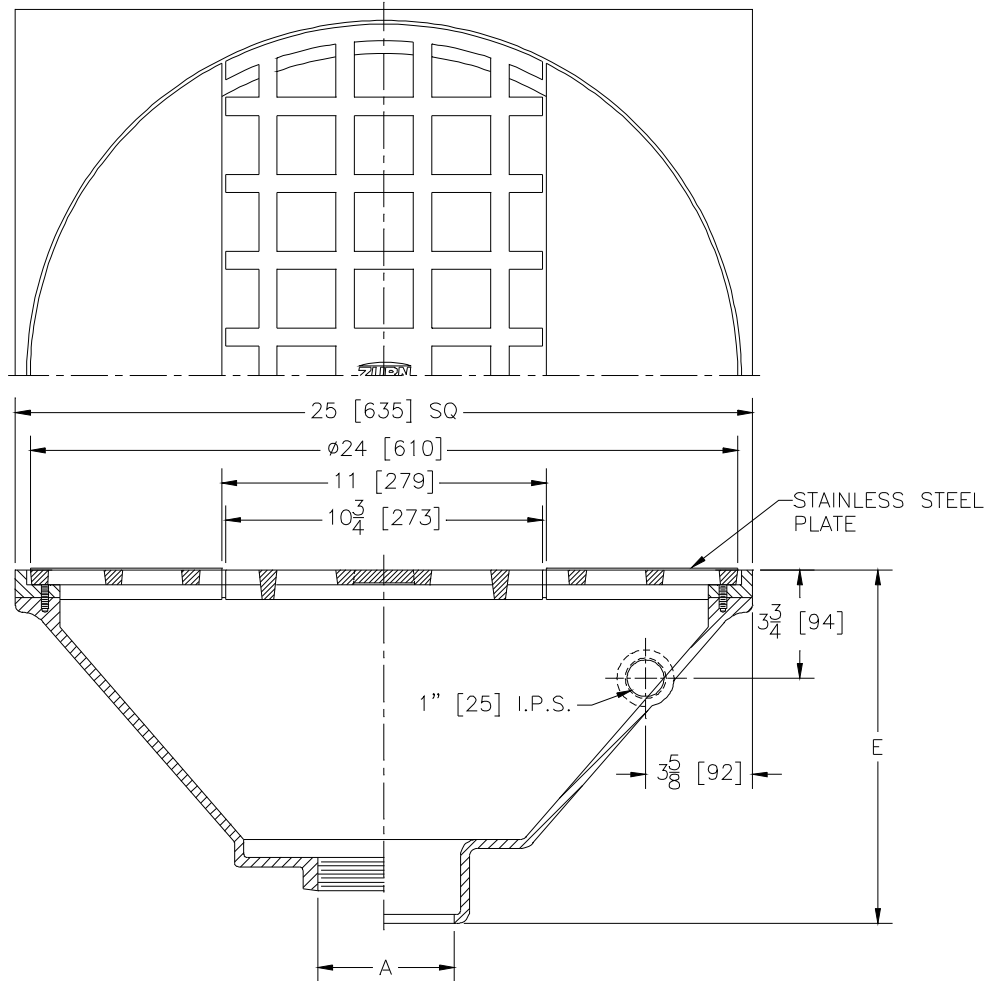

A-Pipe Size Inches	Approx. Wt. Lbs.	Grate Open Area Sq. In.
3-4-5-6-8 [76,102,127,152,203]	118 [53]	136 [877]

ENGINEERING SPECIFICATION: ZURN Z319-78
25" [635] Large Capacity Thoroflush Drain, cast iron body with white acid resistant coating, bottom outlet, and nickel bronze top frame and grate with stainless steel plate.

OPTIONS (Check/specify appropriate options)

OUTLET (Specify type)

- _____ **IC** Inside Caulk
- _____ **IG** Inside Caulk w/Sealtrol Gskt.
- _____ **IP** Threaded

PIPE SIZE (Specify size)

- _____ 3",4",5",6",8" [76,102,127,152,203]
- _____ 3",4",6" [76,102,152]
- _____ 3",4",5",6",8" [76,102,127,152,203]

**'E' BODY HT.
DIMENSION**

- 12-1/8" [308]
- 12-1/8" [308]
- 11" [279]

PREFIXES

- _____ **ZN** Cast Iron Body w/Acid Resistant Coating and Polished Nickel Bronze Top*

SUFFIXES

- _____ **-DC** Dura-Coated Interior
- _____ **-G** Galvanized Cast Iron
- _____ **-P** Trap Primer Connection
- _____ **-V** Backwater Valve (See Z1099)
- _____ **-WB** Water Control Box (See Z1464)

*REGULARLY FURNISHED UNLESS OTHERWISE SPECIFIED

REV. A	DATE: 11/14/07	C.N. NO. 97699
DWG. NO. P-14004		PRODUCT NO. Z319-78