



Z1209-N-X4

SPECIFICATION SHEET

VERTICAL OFFSET SIPHON JET WATER CLOSET SUPPORT SYSTEM W/ 4 INCH [102] "FOOT" EXTENSION

TAG _____

Dimensional Data (inches and [mm]) are Subject to Manufacturing Tolerances and Change Without Notice

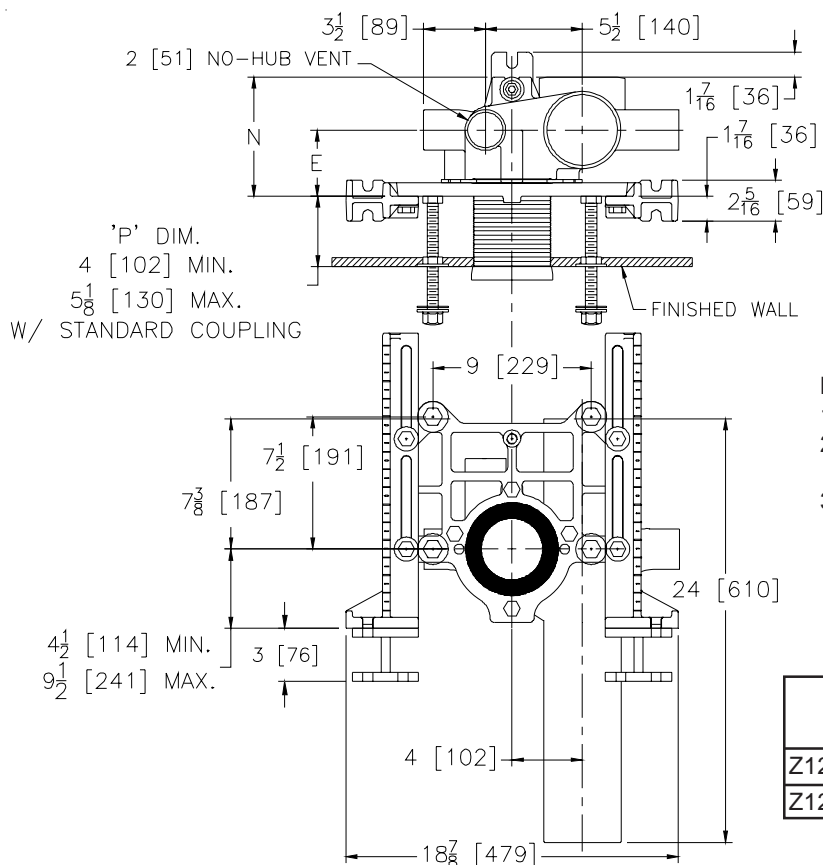
**Note:**

1. Min. 'P' Dim. Obtainable=2 [51]
2. Feet anchored to floor using min. 1/2 [13] dia. anchors through rear slots on carrier feet.
3. Rear anchor foot required for secure installation.

Product No.	Dimension In Inches		Approx. Wt. Lbs. [kg]
	E	N	
Z1209-NL4/NR4-X4	3-3/4[95]	6-3/4[171]	67 [30]
Z1209-HL4/HR4-X4	3-3/4[95]	6-3/4[171]	82 [37]

ENGINEERING SPECIFICATION: ZURN Z1209-N(-)-X4

Vertical Offset Siphon Jet Water Closet "Rigid System" with () size No-Hub or Hub and Spigot connections and 2 [51] vent. Complete with Dura-Coated cast iron main fitting, universal floor mounted foot supports with 4 inch [102] "foot" extensions, adjustable faceplate, corrosion resistant adjustable ABS coupling with integral test cap, fixture bolts, trim, and stud protectors. Rear anchor tie down, and bonded "Neo-Seal" gasket.

PRODUCT/DEFINITION

___ Z1209-NL4-X4	4 [102] No-Hub Stack, Left Hand Offset Inlet, 2 [51] Left Hand Vent
___ Z1209-NR4-X4	4 [102] No-Hub Stack, Right Hand Offset Inlet, 2 [51] Right Hand Vent
___ Z1209-HL4-X4	4 [102] Hub & Spigot Stack, Left Hand Offset Inlet, 2 [51] Left Hand Vent
___ Z1209-HR4-X4	4 [102] Hub & Spigot Stack, Right Hand Offset Inlet, 2 [51] Right Hand Vent

PREFIXES

___ Z	D.C.C.I. System with Zurn "ZZ" Adjustable Coupling
___ ZQ	D.C.C.I. System with N.P.T. Inlet, Non-Adjustable Coupling

SUFFIXES

___ -A	Auxiliary Support Assembly (For P-Dim. greater than 18 [457])	___ -JV	Vent Side 2 [51] Auxiliary Inlet
___ -B	Blowout Type Fixture Support	___ -M	Auxiliary Foot Support (For P-Dim. 10 [254] to 18 [457])
___ -CC	Corrosion Resistant Cast Iron Coupling (6 [152] to 12 [305])	___ -VP	Vandal Proof Trim
___ -CL	Coupling Length Greater than 12 [305] (Specify length Required)	___ -29	Mechanical Test Cap Assembly
___ -F	Floor Mounted, Back Outlet Fixture Support	___ -45	Finishing Frame for Siphon Jet System
___ -G	Galvanized Cast Iron	___ -50	Flush Valve Supply Support for Water Closet
___ -JJ	Two 2 [51] Auxiliary Inlet	___ -61	Adjusting Wrench for "ZZ" Coupling
___ -JS	Stack Side 2 [51] Auxiliary Inlet		

*REGULARLY FURNISHED UNLESS OTHERWISE SPECIFIED

REV. DATE: 07/22/11 C.N. NO. 121665

DWG. NO. 306816 PRODUCT NO. Z1209-N-X4

ZURN INDUSTRIES, LLC. ♦ SPECIFICATION DRAINAGE OPERATION ♦ 1801 Pittsburgh Ave. ♦ Erie, PA 16514

Phone: 814/455-0921 ♦ Fax: 814/454-7929 ♦ World Wide Web: www.zurn.com

In Canada: ZURN INDUSTRIES LIMITED ♦ 3544 Nashua Drive ♦ Mississauga, Ontario L4V1L2 ♦ Phone: 905/405-8272 Fax: 905/405-1292