



Z525-82

**9 [229] DIAMETER ADJUSTABLE
LIGHT DUTY DRAIN W/ 1" SLOTTED GRATE**

SPECIFICATION SHEET

TAG _____

Dimensional Data (inches and [mm]) are Subject to Manufacturing Tolerances and Change Without Notice

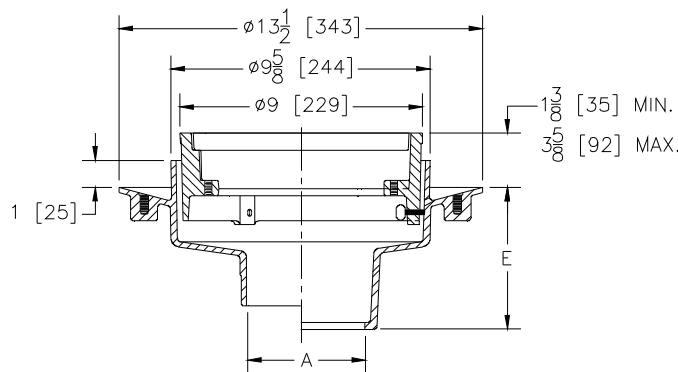
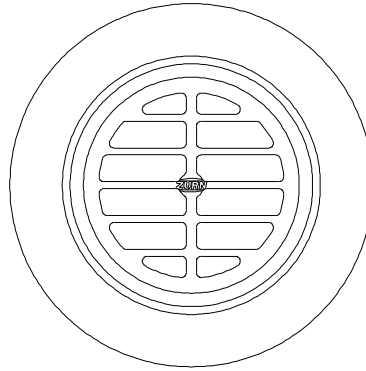

A- Pipe Size In. [mm]	Approx. Wt. Lbs. [kg]	Grate Open Area Sq. In. [cm ²]
2,3,4 [51,76,102]	35 [16]	27 [174]
6 [152]	35 [16]	

ENGINEERING SPECIFICATION: ZURN Z525-82

9" [229mm] Diameter top drain, Dura-Coated cast iron body with bottom outlet, seepage pan and adjustable extension frame with light duty cast iron 1" [25mm] slotted grate.

OPTIONS (Check/specify appropriate options)

PIPE SIZE

(Specify size/type) **OUTLET**

'E' DIM.

2,3,4 [51,76,102]	___ IC Inside Caulk	5-1/4 [133]
2,3,4 [51,76,102]	___ IG Inside Gasket	5-1/4 [133]
2,3,4 [51,76,102]	___ IP Threaded	3-1/2 [89]
2,3,4-6 [51,76,102-152]	___ NH No-Hub	4-1/4 [108]
2,3,4 [51,76,102]	___ NL Neo-Loc	4-3/8 [111]

PREFIXES

___ Z D.C.C.I. Body and Top*

SUFFIXES

___ -C Clamp Collar	___ -SS Stainless Mesh Liner for Bucket
___ -F Extension Frame (4-5/8 [117] Min. - 6-5/8 [168] Max.)	___ -T Square Top (9-5/8 [244])
___ -G Galvanized Cast Iron	___ -TC Neo-Loc Test Cap Gasket (2 [51] - 4 [102] NL Bottom Outlet Only)
___ -P Trap Primer Connection	___ -Y Sediment Bucket
___ -S Secondary Strainer	___ -90 90° Side Outlet Body (See Z1042)

* Regularly furnished unless otherwise specified.