



Z566-88

12 [305] SQUARE OPEN TOP DRAIN

SPECIFICATION SHEET

TAG _____

Dimensional Data (inches and [mm]) are Subject to Manufacturing Tolerances and Change Without Notice

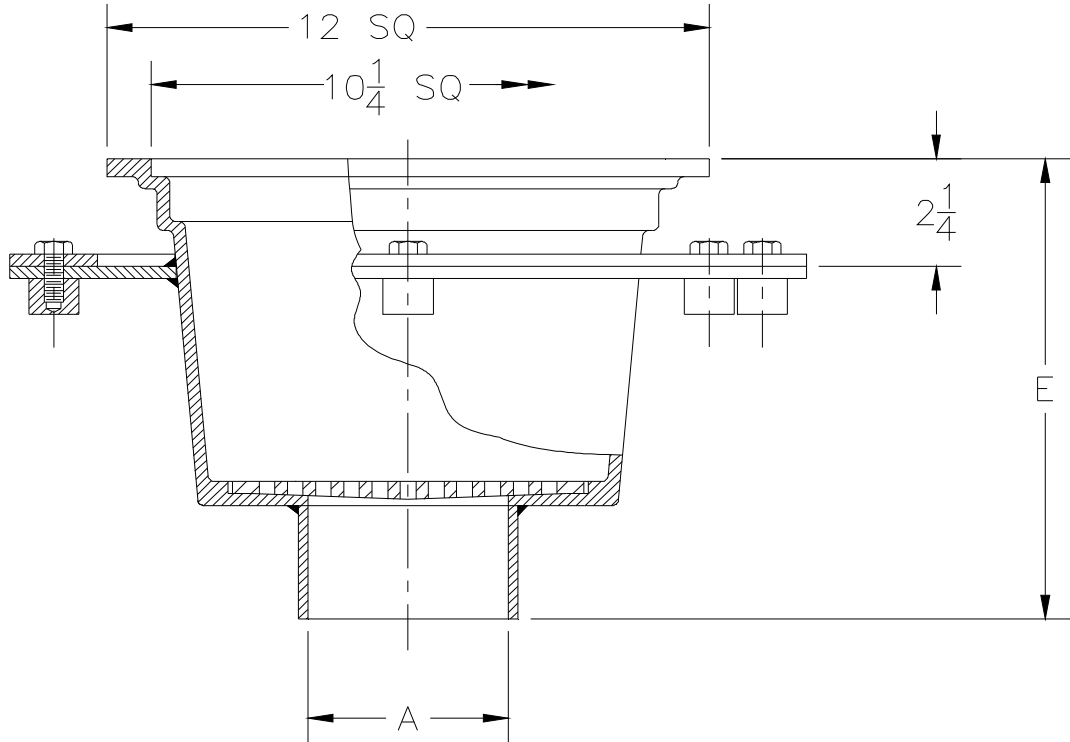

A- Pipe Size In.	Approx. Wt. Lbs. [kg]
2-3-4 [50-75-100]	42 [19]

ENGINEERING SPECIFICATION: ZURN Z566-88 12 [305] Square open top drain, Dura-Coated cast iron body with seepage pan & clamping collar, bottom no-hub outlet and loose set cast iron secondary strainer.

OPTIONS (Check/specify appropriate options)

PIPE SIZE

2,3,4 [51, 76, 100]

(Specify size/type) **OUTLET**

_____ NH No-Hub

'E' BODY HT. DIM.

9 1/4 [235]

PREFIXES

- ___ Z D.C.C.I. Body and Grate*
- ___ ZB D.C.C.I. Body with Polished Bronze Grate (Add 3/16 [5] to 'E' Dim.)
- ___ ZN D.C.C.I. Body with Polished Nickel Bronze Grate (Add 3/16 [5] to 'E' Dim.)

SUFFIXES

- ___ -AR Acid Resisting Epoxy Coated Finish
- ___ -BT Bell Trap Bucket
- ___ -G Galvanized Cast Iron
- ___ -TG Top Grate
- ___ -Y Sediment Bucket

REV.	DATE: 06/13/11	C.N. NO. 121397
DWG. NO. 306241	PRODUCT NO. Z566-88	

*REGULARLY FURNISHED UNLESS OTHERWISE SPECIFIED