



Z211-S HUB DRAIN

SPECIFICATION SHEET

TAG _____



Dimensional Data (inches and [mm]) are Subject to Manufacturing Tolerances and Change Without Notice

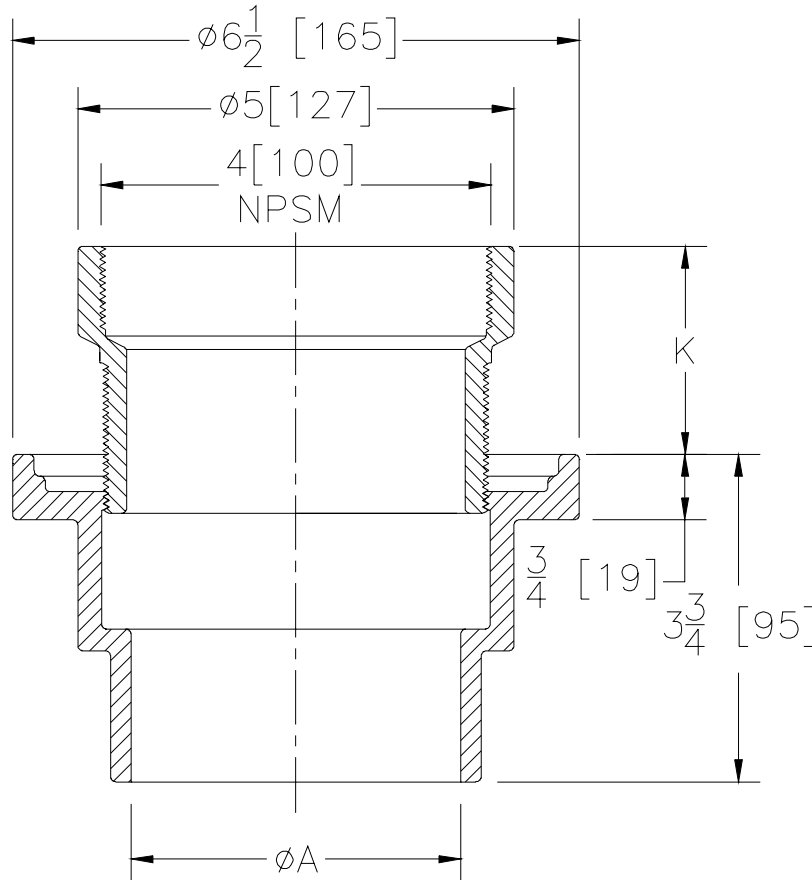

A Pipe Size Inches / [mm]	Body Height Inches / [mm]	Approx. Wt. Lbs. / [kg]
2 - 3 - 4 [51 - 76 - 102]	3-3/4 [95]	4 [2]

ENGINEERING SPECIFICATION: ZURN Z211-S Hub Drain, Dura-Coated cast iron body with bottom outlet.

OPTIONS (Check/specify appropriate options)

PIPE SIZE

2,3,4 [51,76,102]

(Specify size/type) **OUTLET**

_____ NH No-Hub

E BODY HT. DIM.

3 3/4 [95]

SUFFIXES

- _____ -G Galvanized Cast Iron
- _____ -P 1/2" [13mm] Trap Primer Connection
- _____ -X Squeezin Backwater Valve
- _____ -Y Sediment Bucket
- _____ -210 8" [203mm] Wide Flange Body

REV. A DATE: 04/20/07 C.N. NO. 89849

DWG. NO. 63869 PRODUCT NO. Z211-S

*REGULARLY FURNISHED UNLESS OTHERWISE SPECIFIED