



Z100-324

15 [381] DIAMETER MAIN ROOF DRAIN
LOW SILHOUETTE DOME W/ CONTROL FLOW ORIFICE

SPECIFICATION SHEET

TAG _____

Dimensional Data (inches and [mm]) are Subject to Manufacturing Tolerances and Change Without Notice

10-YEAR		100-YEAR
DEPTH (IN), B*	ORIFICE Ø (IN), C*	ORIFICE Ø (IN), D*

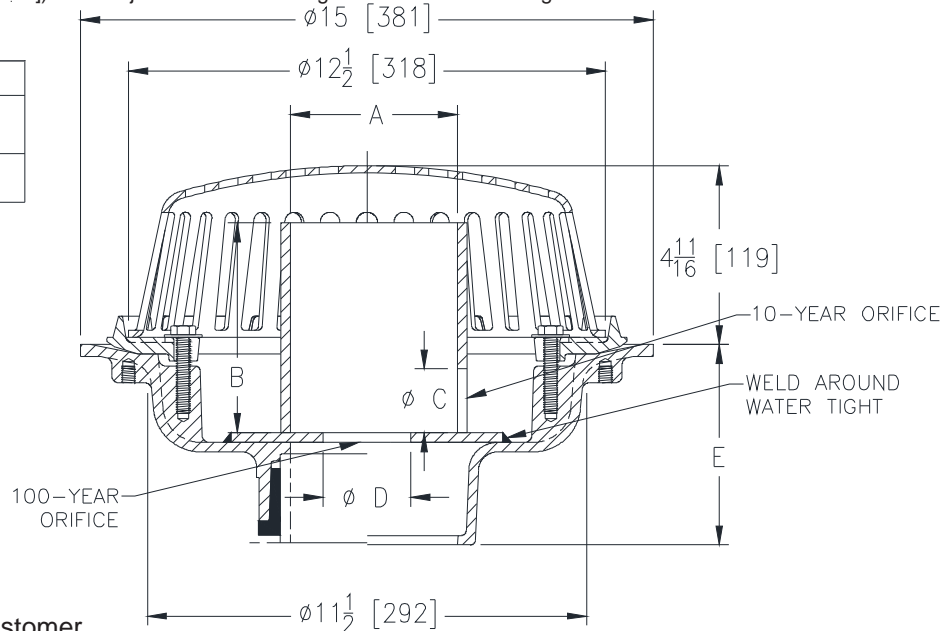

*B, C, & D Dimensions to be specified by customer

A Pipe Size In. [mm]	Approx. Wt. Lbs. [kg]	Dome Open Area Sq. In. [cm ²]
3,4 [76,102]	26 [12]	103 [665]
5,6 [127,152]	27 [12]	
8 [203]	28 [13]	

ENGINEERING SPECIFICATION: ZURN Z100-324

15" [381mm] Diameter roof drain. Dura-Coated cast iron body with combination membrane flashing clamp/gravel guard, low silhouette Poly-Dome, and water dam featuring 10-year and 100-year control flow orifices.

OPTIONS (Check/specify appropriate options)

PIPE SIZE

- 3,4,5,6,8 [76,102,127,152,203]
- 3,4,5,6,8 [76,102,127,152,203]
- 3,4,5,6,8 [76,102,127,152,203]
- 3,4 [76,102]
- 6 [152]

(Specify size/type) OUTLET

- ___ IC Inside Caulk
- ___ IP Threaded
- ___ NH No-Hub
- ___ NL Neo-Loc
- ___ NL Neo-Loc

E BODY HT. DIM.

- 5-1/4 [133]
- 3-3/4 [95]
- 5-1/4 [133]
- 4-9/16 [116]
- 5-7/16 [112]

PREFIXES

- ___ Z D.C.C.I. Body with Poly-Dome**
- ___ ZA D.C.C.I. Body with Aluminum Dome
- ___ ZC D.C.C.I. Body with Cast Iron Dome
- ___ ZRB D.C.C.I. Body with Plain Bronze Dome

SUFFIXES

- | | |
|---|--|
| ___ -AC Angular Underdeck Clamp | ___ -HD 6-3/4 [171] High Aluminum Dome Strainer (148 Sq. In. [955 cm ²] Open Area) (ZA Only) |
| ___ -AR Acid Resistant Epoxy Coated | ___ -R Roof Sump Receiver |
| ___ -BS Bronze Mesh Screen Over Dome | ___ -SC Secondary Clamp Collar |
| ___ -C Underdeck Clamp | ___ -SS Stainless Steel Mesh Screen Over Dome |
| ___ -DE Deck Extension | ___ -ST Dome with Solid Top (ZA, ZC & ZRB Only) |
| ___ -DP Top-Set® Deck Plate (Replaces both the -C and -R) | ___ -VP Vandal-Proof Secured Top |
| ___ -DR Top-Set® Drain Riser | ___ -84 Stainless Steel Perforated Gravel Guard |
| ___ -DX Dex-o-tex Flange | ___ -85 Stainless Steel Perforated Extension |
| ___ -EB Top-Set® Adjustable Extension Assembly | ___ -89 2 [51] High External Water Dam |
| ___ -G Galvanized Cast Iron | |
| ___ -GD Galvanized Cast Iron Dome (ZC Only) | |

** Regularly furnished unless otherwise specified.