



# Z-539-78

## 12" [305] HEAVY DUTY DRAIN WITH DEEP SUMP

TAG \_\_\_\_\_

Dimensional Data (inches and [ mm ]) are Subject to Manufacturing Tolerances and Change Without Notice

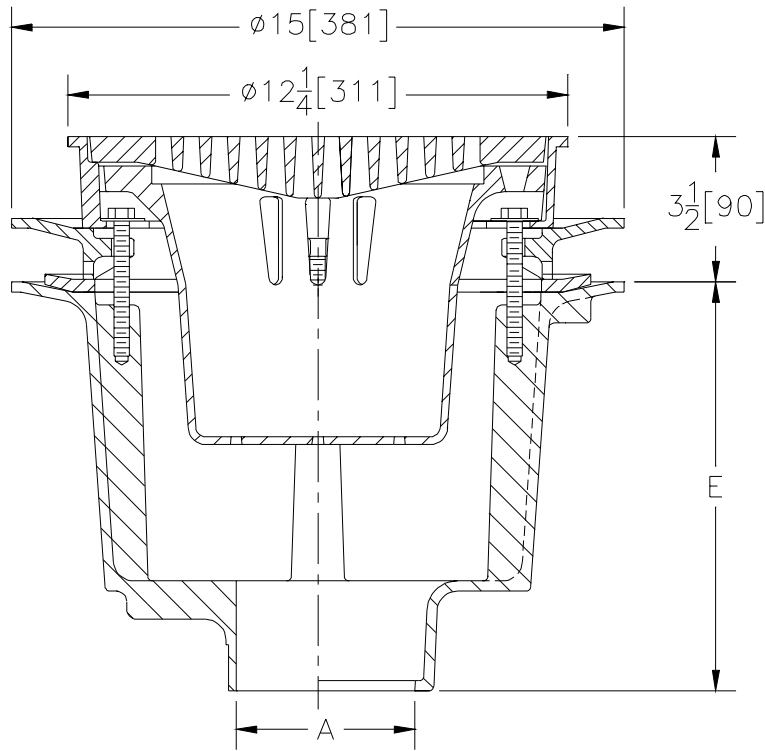

A- Pipe Size In.	Approx. Wt. Lbs. [kg]	Grate Open Area Sq. In. [cm <sup>2</sup> ]
3-4-5-6 [75-100-125-150]	70 [32]	30 [194]
8 [200]		

**ENGINEERING SPECIFICATION: ZURN Z-539-78**  
 12 [305] Diameter top drain. Dura-Coated cast iron deep sump body with bottom outlet, seepage pan and combination membrane flashing clamp, secondary clamp collar, static extension and heavy duty slotted grate with suspended sediment bucket.

**OPTIONS** (Check/specify appropriate options)

PIPE SIZE	(Specify size/type)	OUTLET	'E' BODY HT. DIM.
3 thru 6 [75 thru 150]	_____	IC Inside Caulk	10 [254]
3 thru 6 [75 thru 150]	_____	IG Inside Caulk w/Sealtrol Gskt.	10 [254]
3 thru 6, 8 [75 thru 150, 200]	_____	NH No-Hub	10 [254]

**PREFIXES**

- \_\_\_\_\_ Z- D.C.C.I. Body and Grate\*
- \_\_\_\_\_ ZB- D.C.C.I. Body with Polished Bronze Grate (Add 3/16 [5] to 2 [51] Dim.)
- \_\_\_\_\_ ZN- D.C.C.I. Body with Polished Nickel Bronze Grate (Add 3/16 [5] to 2 [51] Dim.)

**SUFFIXES**

- \_\_\_\_\_ -DG Duresist Grate
- \_\_\_\_\_ -FY Free Standing Bucket
- \_\_\_\_\_ -G Galvanized Cast Iron
- \_\_\_\_\_ -VP Vandal Proof Secured Top

REV.	DATE: 06/03/96	C.N. NO. 75157
DWG. NO. P-14339 PRODUCT NO. Z-539-78		

\*REGULARLY FURNISHED UNLESS OTHERWISE SPECIFIED