

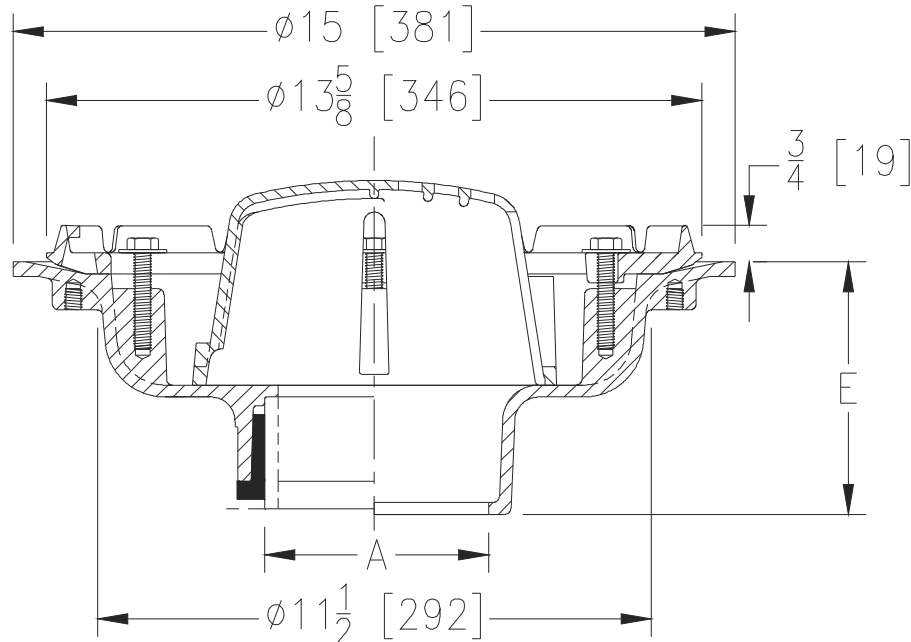

Z108-79

15 [381] DIAMETER DECK RECEPTOR W/ LOW PROFILE TAG CLAMPING COLLAR

Dimensional Data (inches and [mm]) are Subject to Manufacturing Tolerances and Change Without Notice



A Pipe Size In [mm]	Approx. Wt. Lbs. [kg]	Dome Open Area Sq. In. [cm ²]
2, 3, 4 [51, 76, 102]	41 [19]	53 [342]
5, 6 [127, 152]	39 [18]	
8 [203]	42 [19]	

ENGINEERING SPECIFICATION: ZURN Z108

15" [381 mm] Diameter roof drain, Dura-Coated cast iron body with low profile combination membrane flashing clamp, deck receptor frame and internal bottom dome strainer.

OPTIONS (Check/specify appropriate options)

PIPE SIZE

- 2, 3, 4, 5, 6, 8 [51, 76, 102, 127, 152, 203]
- 2, 3, 4, 5, 6, 8 [51, 76, 102, 127, 152, 203]
- 2, 3, 4, 5, 6, 8 [51, 76, 102, 127, 152, 203]
- 2, 3, 4 [51, 76, 102]
- 6 [152]

(Specify size/type) OUTLET

- ___ IC Inside Caulk
- ___ IP Threaded
- ___ NH No-Hub
- ___ NL Neo-Loc
- ___ NL Neo-Loc

'E' BODY HT. DIM.

- 5-1/4 [133]
- 3-3/4 [95]
- 5-1/4 [133]
- 4-9/16 [116]
- 5-7/16 [112]

PREFIXES

- ___ Z D.C.C.I. Body with Collar*

SUFFIXES

- | | |
|---|--|
| ___ -AR Acid Resistant Epoxy Coated | ___ -EB Top-Set® Adjustable Extension Assembly |
| ___ -C Underdeck Clamp | ___ -FG Flush Grate (Replaces Dome Strainer) |
| ___ -DE Deck Extension | ___ -G Galvanized Cast Iron |
| ___ -DP Top-Set® Deck Plate
(Replaces both the -C and -R) | ___ -HD 6-3/4 [171] High Aluminum Dome Strainer
(61 Sq. In. [394 cm ²] Open Area) |
| ___ -DR Top-Set® Drain Riser | ___ -R Roof Sump Receiver |
| ___ -DX Dex-o-tex Flange | ___ -TC Neo-Loc Test Cap Gasket
(2, 3, 4 [51, 76, 102] NL Bottom Outlet
Only) |
| ___ -E Static Extension 1 [25] thru 4 [102] (Specify Ht.) | ___ -90 90° Threaded Side Outlet Body
(2, 3, 4, 5, 6 [51, 76, 102, 127, 152]) |
| ___ -EA Adjustable Extension Assembly
2-1/8 [54] thru 3-1/2 [89] | |

* Regularly furnished unless otherwise specified.