

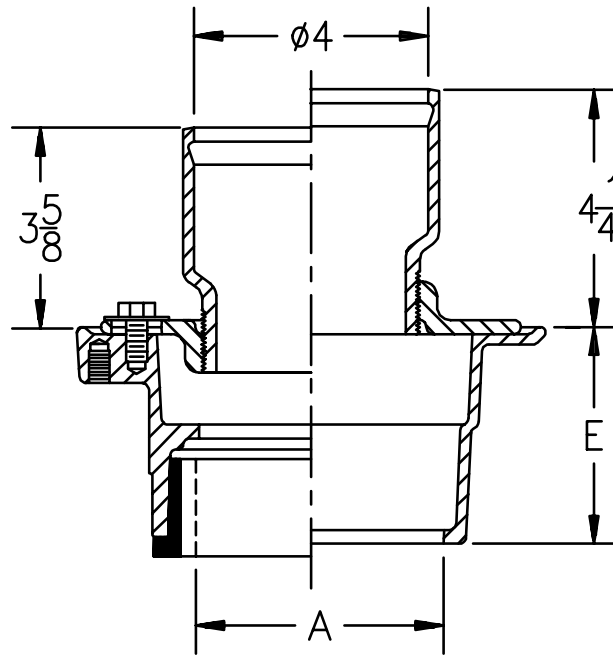

**Z-415-115
BODY ASSEMBLY WITH
HUB ADAPTER**

TAG _____

Dimensional Data (inches and [mm]) are Subject to Manufacturing Tolerances and Change Without Notice



Dimensions In Inches	Approx. Wt. Lbs.
A Pipe Size	
2-3-4-6	18

ENGINEERING SPECIFICATION: ZURN ZN-415-115 Floor and shower drain, Dura-Coated cast iron body with bottom outlet, combination invertible membrane clamp and Dura-Coated cast iron hub adapter.

OPTIONS (Check/specify appropriate options)

OUTLET (Specify type)

- ___ **IC** Inside Caulk
- ___ **IP** Threaded
- ___ **IP** Threaded
- ___ **IP** Threaded
- ___ **IP** Threaded
- ___ **NH** No-Hub
- ___ **NL** Neo-Loc

PIPE SIZE (Specify size)

- ___ 2" thru 4"
- ___ 2"
- ___ 3"
- ___ 4"
- ___ 6"
- ___ 2" thru 4"
- ___ 2" thru 4"

'E' BODY HT. DIMENSION

- 3-7/8"
- 2-3/8"
- 2-5/8"
- 2-7/8"
- 2-3/4"
- 3-7/8"
- 4-5/8"

PREFIXES

- ___ **ZB-** D.C.C.I. Body Assembly
- ___ **ZN-** D.C.C.I. Body Assembly*

SUFFIXES

- ___ **-AR** Acid Resisting Epoxy Finish
- ___ **-G** Galvanized Cast Iron
- ___ **-P** Primer Connection (Specify 1/2" or 3/4")
- ___ **-90** 90° Side Outlet Body (2",3" only)
(Previously Z-430)

REV.	DATE: 06/29/95	C.N. NO. 72354
DWG. NO. P-14197 PRODUCT NO. Z-415-115		

*REGULARLY FURNISHED UNLESS OTHERWISE SPECIFIED