



# Z1199-77

## AUTO-DRAW-OFF GREASE INTERCEPTOR W/ 4 [102] INLET/OUTLET

SPECIFICATION SHEET

TAG \_\_\_\_\_

Dimensional Data (inches and [ mm ]) are Subject to Manufacturing Tolerances and Change Without Notice

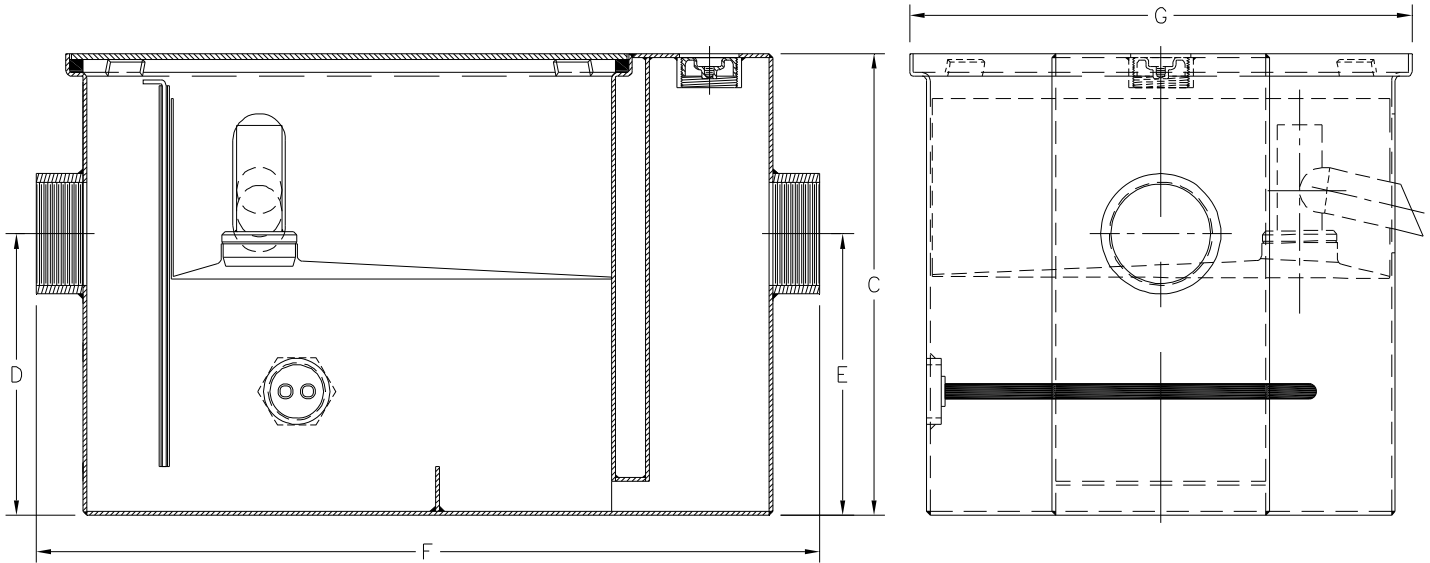

Size	Inlet/Outlet Size	Maximum G.P.M. [L.P.M]	Capacity		Approx. Wt. Lbs. [kg]	Dimensions in Inches [mm]			
			Water Gal. [L]	Grease Lbs. [kg]		C	D/E	F	G
400	4 [102]	15 [57]	10 [38]	30 [14]	93 [42]	15-3/8 [391]	9-7/8 [251]	26-1/8 [664]	16-3/4 [425]
800		50 [189]	40 [151]	100 [45]	190 [86]	23-1/2 [597]	16-1/2 [419]	35 [889]	24-1/2 [622]

### ENGINEERING SPECIFICATION: ZURN Z1199-77

All type 304 stainless steel grease interceptor, rated at \_\_\_\_\_ GPM and \_\_\_\_\_ Lbs. grease capacity, with automatic grease draw-off, 120V AC heater bronze cleanout plug, removable pressure equalizing/flow diffusing inlet baffle, fixed bottom sediment baffle, and visible double wall trap seal. Gasketed non-skid secured cover and Z1108 flow control fitting. Regularly furnished with a high inlet and outlet connection. Note: Location of inlet and outlet from bottom of interceptor cannot be changed.

### PREFIXES

\_\_\_\_\_ Z All Type 304 Fabricated Stainless Steel\*

### SUFFIXES

- \_\_\_\_\_ -AL Aluminum Cover
- \_\_\_\_\_ -L Angle type (Z1108-L) flow control device with plunger.

**Note: For above floor use only, cannot be recessed.**

\* Regularly furnished unless otherwise specified.