



**Z1183-102**  
**SOLIDS INTERCEPTOR**  
**28 [711] TALL**

SPECIFICATION SHEET

TAG \_\_\_\_\_

Dimensional Data (inches and [ mm ]) are Subject to Manufacturing Tolerances and Change Without Notice

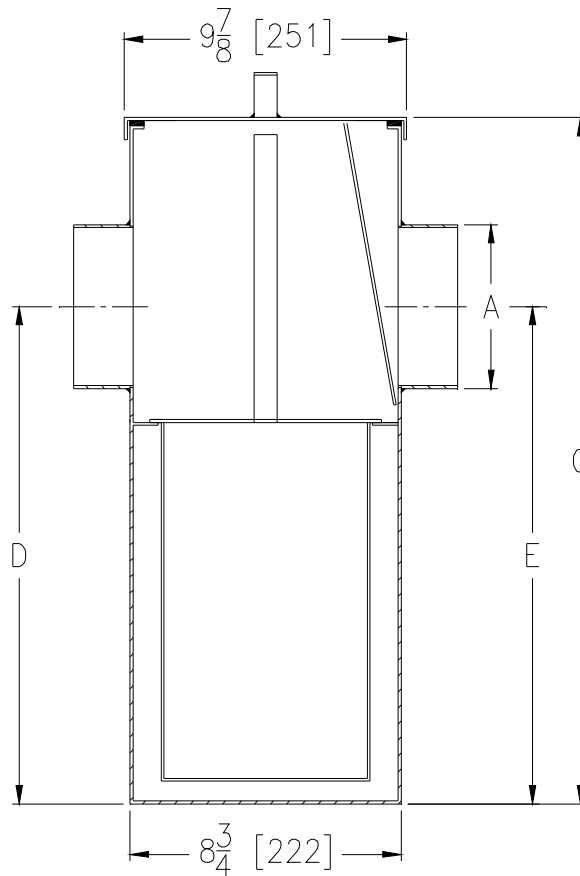

INLET      G=WIDTH OF BODY      OUTLET

Size	Inlet/Outlet Size	Flow Rate G.P.M. [LPM]	Solids Cap. Cubic Ft. [m <sup>3</sup> ]	Dimensions in Inches [mm]			Approx. Wt. lbs. [kg]
				C	G	D/E	
800	4 [102]	50 [189]	1.35 [.038]	28 [711]	24-1/2 [622]	16 [406]	59 [27]

**ENGINEERING SPECIFICATION:** ZURN Z1183-102 Large capacity acid resistant coated fabricated steel, or stainless steel, solids interceptor, for on floor or semi-recessed installation cores with screen attached to gasketed, removable, latched lid, and removable sediment basket. Size to be used with corresponding Z1170, Z1172 or Z1173 Grease Interceptors.

**PREFIXES**

- \_\_\_\_\_ Z      Acid Resistant Coated Fabricated Steel\*
- \_\_\_\_\_ ZS     All Type 304 Fabricated Stainless Steel

**SUFFIXES**

- \_\_\_\_\_ -CS    Custom Screens (Specify material and perforation size required)
- \_\_\_\_\_ -YR    Replacement Stainless Steel Bucket Assembly

\* Regularly furnished unless otherwise specified.