



Z1750-164

12 x 12 [305 x 305] SANI-FLOR RECEPTOR 6 [152] SUMP
DEPTH WITH 40 MESH SEDIMENT BUCKET

SPECIFICATION SHEET

TAG _____

Dimensional Data (inches and [mm]) are Subject to Manufacturing Tolerances and Change Without Notice

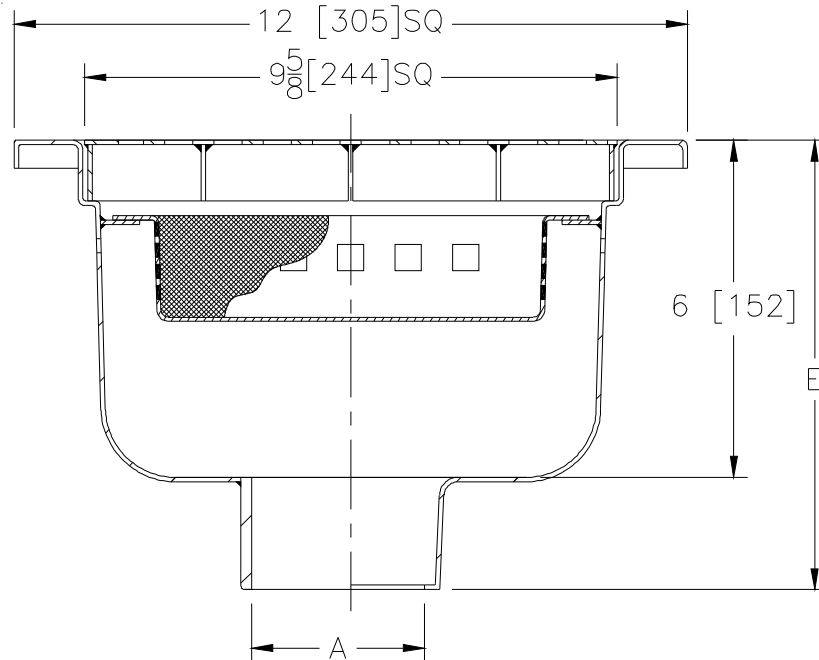

A - Pipe Size Inches [mm]	Approx. Wt. Lbs. [kg]	Grate Open Area Sq. In. [cm ²]
2,3,4 [51,76,102]	15 [7]	23 [148]

ENGINEERING SPECIFICATION: ZURN Z1750-164
12" x 12" x 6" [305mm x 305mm x 152mm] Deep, 14 gage, All Type 304 (CF8) stainless steel light duty Sani-Flor receptor with non-tilt, loose set full grate with 1/2" [13mm] square openings, suspended stainless steel sediment bucket with 40 mesh liner.

OPTIONS (Check/specify appropriate options)

PIPE SIZE

- 2,3,4 [51,76,102]
- 2,3,4 [51,76,102]
- 2,3,4 [51,76,102]

(Specify size/type) **OUTLET**

- ___ IC Inside Caulk
- ___ NH No-Hub
- ___ NL Neo-Loc

'E' BODY HT. DIM.

- 8-9/16 [217]
- 8-1/16 [205]
- 7-13/16 [198]

PREFIXES

- ___ Z Type 304 (CF8) Stainless Steel Body*
- ___ ZM Type 316 (CF8M) Stainless Steel

SUFFIXES

- ___ -DX Dex-O-Tex Flange
- ___ -HD Extra Heavy Duty Top Frame & Grate
- ___ -HP Heel-Proof Grate
- ___ -K Seepage Pan
- ___ -KC Seepage Pan With Clamp Collar
- ___ -P 1/2 [13] Trap Primer Connection
- ___ -2 1/2 Grate
- ___ -3 3/4 Grate
- ___ -4 Full Grate With 3 Square Openings
- ___ -5 Grate w/4 [102] diameter x 3-3/4 [95] High Funnel
- ___ -8 Grate w/8-3/8 [213] x 3-5/8 [92] x 3-3/4 [95] High Oval Funnel

* Regularly furnished unless otherwise specified.