



# Z100-346

## 15 [381] DIAMETER MAIN ROOF DRAIN WITH 5 [127] HIGH EXTERNAL WATER DAM

SPECIFICATION SHEET

TAG \_\_\_\_\_

Dimensional Data (inches and [ mm ]) are Subject to Manufacturing Tolerances and Change Without Notice

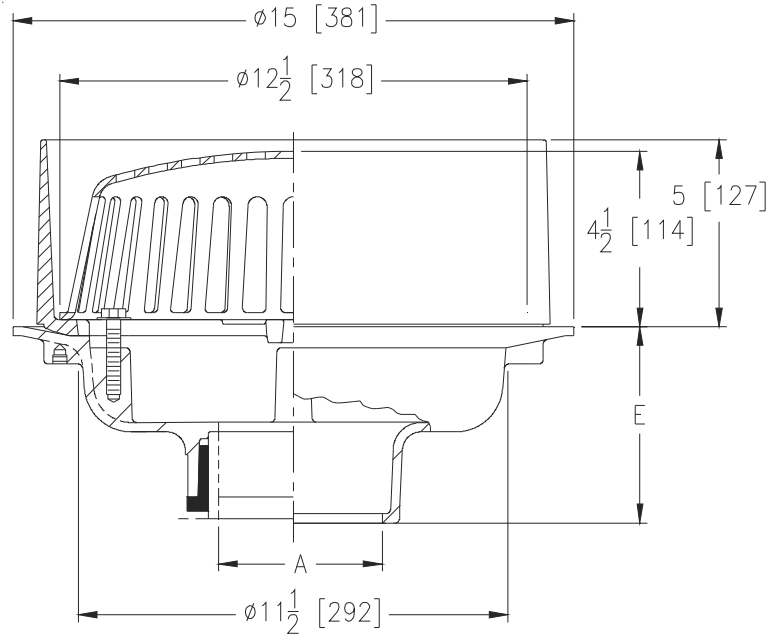

A - Pipe Size Inches [mm]	Approx. Wt. Lbs. [kg]	Dome Open Area Sq. In. [cm <sup>2</sup> ]
2,3,4 [51,76,102]	28 [13]	103 [665]
6 [152]	29 [13]	
8 [203]	30 [14]	

### ENGINEERING SPECIFICATION: ZURNZ100-346

15" [381mm] Diameter roof drain. Dura-Coated cast iron body with 5" [127mm] high combination membrane flashing clamp/gravel guard, and low silhouette Poly-Dome strainer.

### OPTIONS (Check/specify appropriate options)

#### PIPE SIZE

- 3,4,6 [76,102,152]
- 2,3,4,6, 8 [51,76,102,152,203]
- 2,3,4,6, 8 [51,76,102,152,203]
- 2,3,4 [51,76,102]
- 6 [152]

#### (Specify size/type) OUTLET

- \_\_\_ IC Inside Caulk
- \_\_\_ IP Threaded
- \_\_\_ NH No-Hub
- \_\_\_ NL Neo-Loc
- \_\_\_ NL Neo-Loc

#### 'E' BODY HT. DIM.

- 5-1/4 [133]
- 3-3/4 [95]
- 5-1/4 [133]
- 4-5/8 [117]
- 5-7/16 [138]

#### PREFIXES

- \_\_\_ Z D.C.C.I. Body with Poly-Dome\*
- \_\_\_ ZA D.C.C.I. Body with Aluminum Dome
- \_\_\_ ZC D.C.C.I. Body with Cast Iron Dome
- \_\_\_ ZRB D.C.C.I. Body with Plain Bronze Dome

#### SUFFIXES

- |  |   |
|--|---|
| ___ -AC Angular Underdeck Clamp                                  | ___ -FG Flush Grate (Replaces Dome Strainer)  |
| ___ -AR Acid Resistant Epoxy Coated                              | ___ -G Galvanized Cast Iron   |
| ___ -C Underdeck Clamp   | ___ -HD 6-3/4 [171] High Aluminum Dome (148 sq. in. [955 cm <sup>2</sup> ] open area) |
| ___ -DE Deck Extension (Includes Deck Plate -DP)                 | ___ -R Roof Sump Receiver   |
| ___ -DP Top-Set® Roof Deck Plate (Replaces both -C and -R)       | ___ -SS Stainless Steel Mesh Screen Over Dome   |
| ___ -DR Top-Set Adjustable Drain Riser Extension Assembly        | ___ -ST Dome w/ Solid Top (ZA and ZC Only)  |
| ___ -E Static Extension 1 [25] thru 4 [102] (Specify Ht.)        | ___ -TC Neo-Loc Test Cap Gasket (2,3,4 [51,76,102] NL Bottom Outlet Only)             |
| ___ -EA Adjustable Extension Assembly 2-1/8 [54] thru 3-1/2 [89] | ___ -VP Vandal Proof Secured Top  |
| ___ -EB Top-Set Adjustable Extension Assembly                    | ___ -84 Stainless Steel Perforated Gravel Guard                                       |
|  | ___ -90 90° Threaded Side Outlet Body   |

\* Regularly furnished unless otherwise specified.