



Z415B-81

BODY ASSEMBLY W/ "TYPE B" GASKETED STRAINER & DEX-O-TEX FLANGE

SPECIFICATION SHEET

TAG _____

Dimensional Data (inches and [mm]) are Subject to Manufacturing Tolerances and Change Without Notice

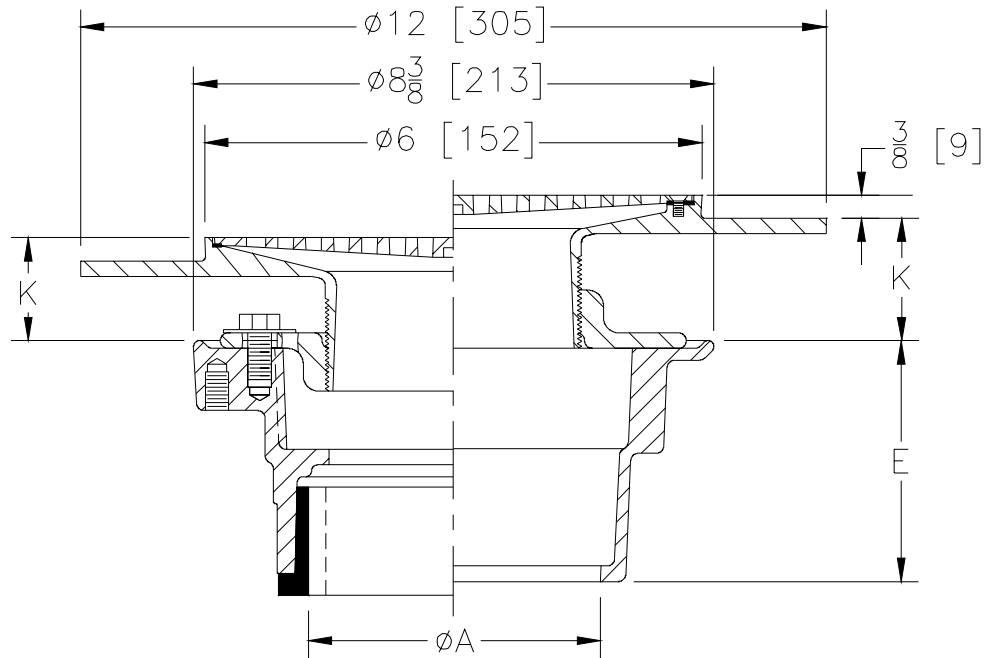

Dimensions In Inches					Approx. Wt. Lbs. [Kg.]	Strainer Open Area Sq. In. [Cm ²]
A Pipe Size	K		K'			
	Min.	Max.	Min.	Max.		
2-3-4 [51-76-102]	3/4 [19]	1 3/4 [44]	1 5/8 [41]	2 3/4 [70]	13 [6]	9 [58]

ENGINEERING SPECIFICATION: ZURN Z415B-81 Floor and shower drain, Dura-Coated cast iron body with bottom outlet, combination invertible membrane clamp and adjustable collar with "TYPE B" polished stainless head and strainer, Dex-o-tex flange, complete with replaceable smooth stainless steel gasketed strainer.

OPTIONS (Check/specify appropriate options)

PIPE SIZE

- 2 thru 4 [51 thru 102]
- 2 [51]
- 3 [76]
- 4 [102]
- 6 [152]
- 2 thru 4 [51 thru 102]
- 2 thru 4 [51 thru 102]

(Specify type/size) **OUTLET**

- _____ **IC** Inside Caulk
- _____ **IP** Threaded
- _____ **IP** Threaded
- _____ **IP** Threaded
- _____ **IP** Threaded
- _____ **NH** No-Hub
- _____ **NL** Neo-Loc

'E' BODY HT. DIMENSION

- 3 7/8 [98]
- 2 3/8 [60]
- 2 5/8 [67]
- 2 7/8 [73]
- 2 3/4 [70]
- 3 7/8 [98]
- 4 5/8 [117]

PREFIXES

- _____ **ZS** D.C.C.I. Body Assembly with 6 [152] Dia. Stainless Steel Top*

SUFFIXES

- _____ **-AR** Acid Resisting Epoxy Coated Cast Iron
- _____ **-G** Galvanized Cast Iron
- _____ **-HD** Heavy-Duty Slotted Grate (5 [127] & 6 [152] Only)
- _____ **-P** Primer Connection (Specify 1/2 [13] or 3/4 [19])
- _____ **-U** 1 - 3 [25 - 76] High Extension Adapter
- _____ **-V** Backwater Valve
- _____ **-VP** Vandal-Proof Secured Top
- _____ **-Y** Sediment Bucket
- _____ **-90** 90° Side Outlet Body (2 [51], 3 [76] Only)

REV. A	DATE: 02/20/04	C.N. NO. 91958
DWG. NO. P-14079	PRODUCT NO. Z415B-81	

*REGULARLY FURNISHED UNLESS OTHERWISE SPECIFIED