



# Z100-228

SPECIFICATION SHEET

15 [381] DIAMETER OVERFLOW DRAIN W/ LOW SILHOUETTE  
DOME AND 10 [254] OUTLET

TAG \_\_\_\_\_

Dimensional Data (inches and [mm]) are Subject to Manufacturing Tolerances and Change Without Notice

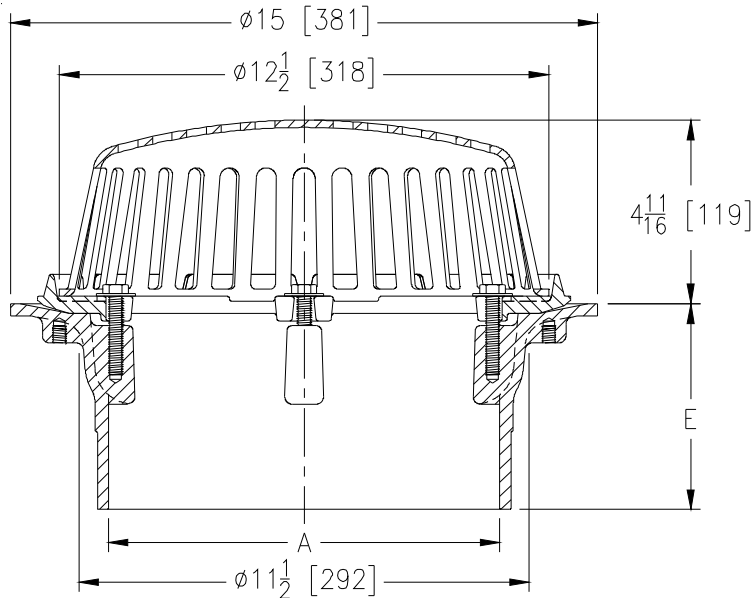

A Pipe Size In.	Approx. Wt. Lbs. [kg]	Dome Open Area Sq. In. [cm <sup>2</sup> ]
10 [254]	30 [14]	103 [665]

**ENGINEERING SPECIFICATION: ZURN Z100-228**

15 [381] Diameter overflow drain. Dura-Coated cast iron body with combination membrane flashing clamp/gravel guard and low silhouette Poly-Dome. For use as overflow drain only.

**OPTIONS** (Check/specify appropriate options)

**PIPE SIZE**

- 10 [254]
- 10 [254]
- 10 [254]

(Specify type) **OUTLET**

- \_\_\_\_\_ IC Inside Caulk
- \_\_\_\_\_ IP Threaded
- \_\_\_\_\_ NH No-Hub

**E BODY HT. DIM.**

- 5 1/4 [133]
- 3 3/4 [95]
- 5 1/4 [133]

**PREFIXES**

- \_\_\_\_\_ Z D.C.C.I. Body with Poly-Dome\*
- \_\_\_\_\_ ZA D.C.C.I. Body with Aluminum Dome
- \_\_\_\_\_ ZC D.C.C.I. Body with Cast Iron Dome
- \_\_\_\_\_ ZRB D.C.C.I. Body with Plain Bronze Dome

**SUFFIXES**

- |   |  |
|---|--|
| _____ -AC Angular Underdeck Clamp   | _____ -R Roof Sump Receiver                    |
| _____ -AR Acid Resistant Epoxy Coated   | _____ -SC Secondary Clamp Collar               |
| _____ -C Underdeck Clamp  | _____ -VP Vandal-Proof Secured Top             |
| _____ -DE Deck Extension  | _____ -W2 2 [51] Internal Water Dam            |
| _____ -DP Top-Set® Deck Plate (Replaces both the -C and -R)   | _____ -85 Stainless Steel Perforated Extension |
| _____ -DR Top-Set® Drain Riser  | _____ -89 2 [51] High External Water Dam       |
| _____ -DX Dex-o-tex Flange  |  |
| _____ -E Static Extension 1 [25] thru 4 [102] (Specify Ht.)   |  |
| _____ -EA Adjustable Extension Assembly<br>2 1/8 [54] thru 3 1/2 [89]   |  |
| _____ -EB Top-Set® Adjustable Extension Assembly  |  |
| _____ -G Galvanized Cast Iron   |  |
| _____ -GD Galvanized Cast Iron Dome (ZC Only)   |  |
| _____ -HD 6 3/4 [171] High Aluminum Dome Strainer<br>(148 Sq. In. [955 cm <sup>2</sup> ] Open Area) (ZA Only) |  |

REV. A DATE: 10/21/10 C.N. NO. 111921

DWG. NO. 302916 PRODUCT NO. Z100-228

\*REGULARLY FURNISHED UNLESS OTHERWISE SPECIFIED

ZURN INDUSTRIES, LLC ♦ SPECIFICATION DRAINAGE OPERATION ♦ 1801 Pittsburgh Ave. ♦ Erie, PA 16514

Phone: 814/455-0921 ♦ Fax: 814/454-7929 ♦ World Wide Web: www.zurn.com

In Canada: ZURN INDUSTRIES LIMITED ♦ 3544 Nashua Drive ♦ Mississauga, Ontario L4V1L2 ♦ Phone: 905/405-8272 Fax: 905/405-1292