



Z511-88

9 [229] DIAMETER HEAVY DUTY DRAIN W/ AUX. INLET CONN., BACKWATER VALVE, & NL OUTLET

SPECIFICATION SHEET

TAG _____

Dimensional Data (inches and [mm]) are Subject to Manufacturing Tolerances and Change Without Notice

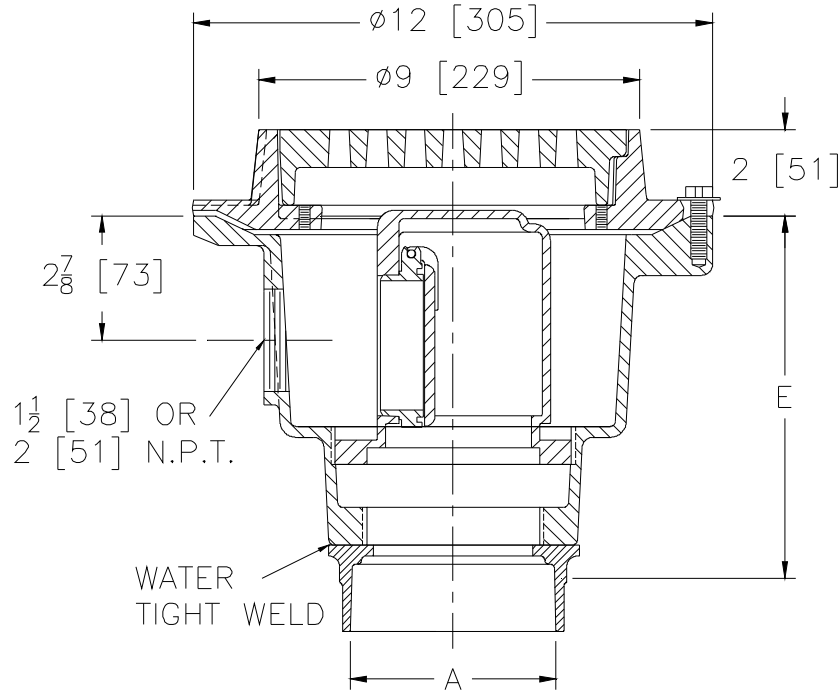

A-Pipe Size In. [mm]	Approx. Wt. Lbs. [kg]	Grate Open Area Sq. In. [cm ²]
3 [76]	50 [23]	18 [116]

ENGINEERING SPECIFICATION: ZURN Z511-88

9" [229mm] Diameter top drain, Dura-Coated cast iron deep sump body with 2" [51mm] auxiliary inlet (Specify 1-1/2" [38mm] or 2" [51mm] I.P., number & location) connection, welded on 3" [76mm] Neo-Loc bottom outlet, seepage pan, combination membrane flashing clamp and frame for heavy duty cast iron deep flange grate with backwater valve.

OPTIONS (Check/specify appropriate options)

PIPE SIZE

3 [76]

(Specify size/type) OUTLET

___ NL Neo-Loc

'E' BODY HT. DIM.

9-1/2 [241]

PREFIXES

- ___ Z D.C.C.I. Body and Grate*
- ___ ZB D.C.C.I. Body with Polished Bronze Grate (Add 3/16 [5] to 2 [51] Dim. & 5/8 [16] to 9 [229] Dim.)
- ___ ZN D.C.C.I. Body with Polished Nickel Bronze Grate (Add 3/16 [5] to 2 [51] Dim. & 5/8 [16] to 9 [229] Dim.)

SUFFIXES

- ___ -AR Acid Resisting Epoxy Coated Coated Finish
- ___ -DG Duresist Grate
- ___ -F 2 [51] Extension Frame
- ___ -FC 2 [51] Extension Frame and Secondary Clamp Collar
- ___ -G Galvanized Cast Iron
- ___ -P Trap Primer Connection
- ___ -VP Vandal Proof Secured Top

* Regularly furnished unless otherwise specified.