



Z1173-TD-86

SIZE 900 GREASE INTERCEPTOR W/ GREASE ACCUMULATING CONE, INLINE SHUTOFF VALVE, 4 [102] CONNECTIONS, & RECESSING RECEIVER

SPECIFICATION SHEET

TAG _____

Dimensional Data (inches and [mm]) are Subject to Manufacturing Tolerances and Change Without Notice

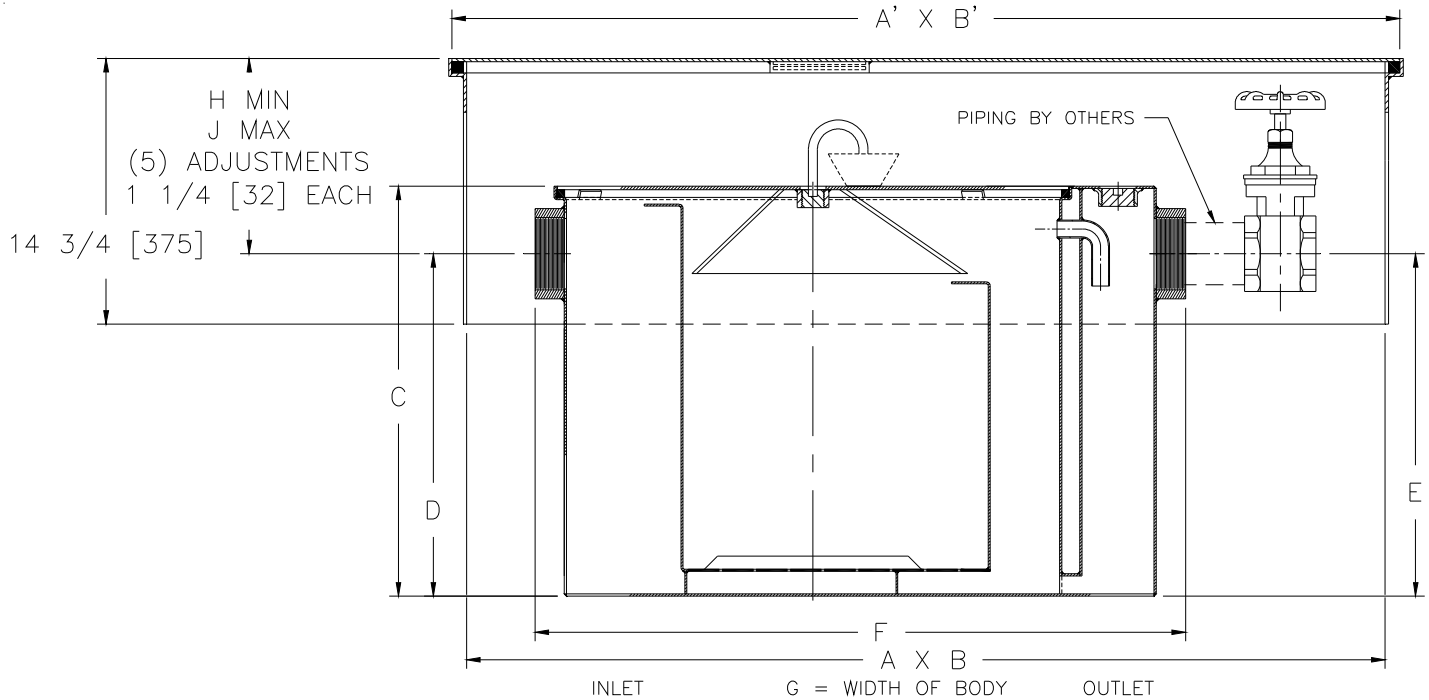

Size	Inlet/Outlet Size**	Flow Rate GPM. [L]	Capacity		Approx. Wt. Lbs. [kg]
			Water Gal. [L]	Grease Lbs. [kg]	
900	4 [102]	75 [284]	65 [246]	150 [68]	372 [169]

Dimensions in Inches [mm]										
Size	A	A'	B	B'	C	D/E	F	G	H	J
900	51 [1295]	53 [1346]	32 [813]	34 [864]	22-3/4 [578]	19 [483]	36 [914]	28-5/8 [727]	6-1/4 [159]	12-1/2 [318]

ENGINEERING SPECIFICATION: ZURNZ1173-TD-86

Size 900 Acid Resistant Coated interior and exterior fabricated steel grease interceptor, rated at 75 GPM and 150 Lbs. grease capacity, with internal air relief by-pass, bronze cleanout plug and visible double wall trap seal with removable combination pressure equalizing/flow diffusing baffle and sediment tray. Gasketed non-skid secured cover with draw off port having bronze plug, grease accumulating cone, NPT to hose adaptor, 2' [610] flexible hose, hose clamp, and an in line closure valve. Complete with Acid Resistant Coated interior and exterior fabricated steel repressing receiver with adjustable support brackets and gasketed non-skid cover with covered recessed lift handle and Z1108 Flow Control Fitting. Regularly furnished inlet and outlet in high position. Note: Location of outlet from bottom of interceptor cannot be changed.

PREFIXES

____ Z Acid Resistant Coated Fabricated Steel*

SUFFIXES

- ____ -L Angle type (Z1108-L) flow control device with plunger (no additional charge).
- ____ -RE Acid Resistant Coated interior and exterior fabricated steel repressing receiver, enclosed type, for recessed installation. Furnished with adjustable support brackets and gasketed non-skid cover with covered recessed lift handle.

*REGULARLY FURNISHED UNLESS OTHERWISE SPECIFIED

REV.	DATE: 05/10/13	C.N. NO. 129328
PROD/DWG. NO. Z1173-TD-86		