

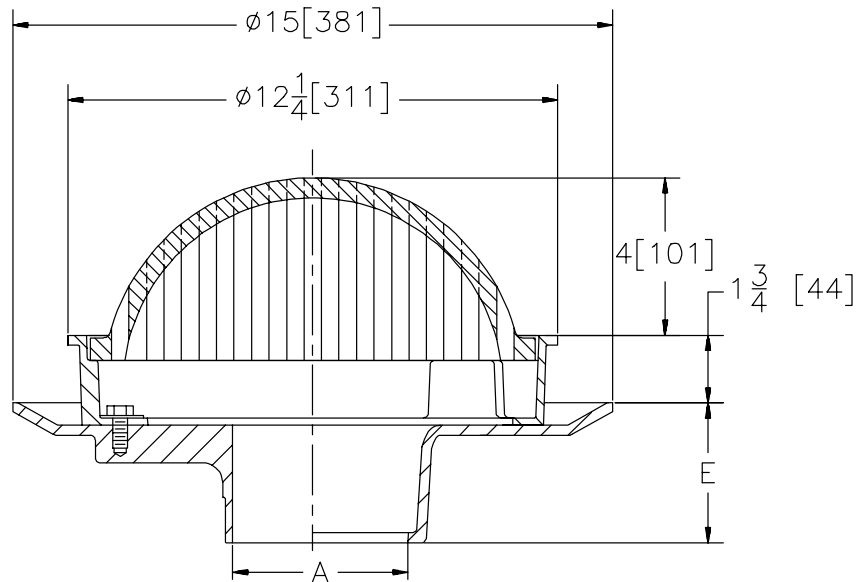

**Z-504-75**  
**12" [305] MEDIUM DUTY DRAIN**

TAG \_\_\_\_\_

Dimensional Data (inches and [ mm ]) are Subject to Manufacturing Tolerances and Change Without Notice



A- Pipe Size In.	Approx. Wt. Lbs. [kg]	Grate Open Area Sq. In. [cm <sup>2</sup> ]
3-4-6 [75-100-150]	32 [15]	30 [194]

**ENGINEERING SPECIFICATION:** ZURN Z-504-75 12 [305] Diameter top drain, Dura-Coated cast iron body with bottom outlet, seepage pan and combination membrane flashing clamp and frame for dome grate.

**OPTIONS** (Check/specify appropriate options)

PIPE SIZE	(Specify size/type) OUTLET	'E' BODY HT. DIM.
3, 4, 6 [75, 100, 150]	___ IC Inside Caulk	3 1/2 [89]
3, 4, 6 [75, 100, 150]	___ IG Inside Caulk w/Sealtrol Gskt.	3 1/2 [89]
3, 4, 6 [75, 100, 150]	___ IP Threaded	3 1/2 [89]
3, 4, 6 [75, 100, 150]	___ NH No-Hub	3 1/2 [89]
3, 4 [75, 100]	___ NL Neo-Loc	2 5/8 [67]

**PREFIXES**

- \_\_\_ Z- D.C.C.I. Body and Grate\*
- \_\_\_ ZB- D.C.C.I. Body with Polished Bronze Grate (Add 3/16 [5] to 1 3/4 [44] Dim.)
- \_\_\_ ZN- D.C.C.I. Body with Polished Nickel Bronze Grate (Add 3/16 [5] to 1 3/4 [44] Dim.)

**SUFFIXES**

- \_\_\_ -AR Acid Resisting Epoxy Coated Cast Iron
- \_\_\_ -DG Duresist Grate
- \_\_\_ -F Extension Frame
- \_\_\_ -G Galvanized Cast Iron
- \_\_\_ -HT Square Hinged Grate
- \_\_\_ -S Secondary Strainer
- \_\_\_ -SC Solid Cover
- \_\_\_ -T Square Top
- \_\_\_ -TS Top Secured With Slotted Screws
- \_\_\_ -V Backwater Valve (See Z-1099)
- \_\_\_ -VP Vandal Proof Secured Top
- \_\_\_ -Y Sediment Bucket

REV.	DATE: 4/4/96	C.N. NO. 74839
DWG. NO. P-14308 PRODUCT NO. Z-504-75		

\*REGULARLY FURNISHED UNLESS OTHERWISE SPECIFIED