



Z121-121

12 [305] DIAMETER ROOF DRAIN WITH
STAINLESS STEEL GASKETED COVER

SPECIFICATION SHEET

TAG _____

Dimensional Data (inches and [mm]) are Subject to Manufacturing Tolerances and Change Without Notice

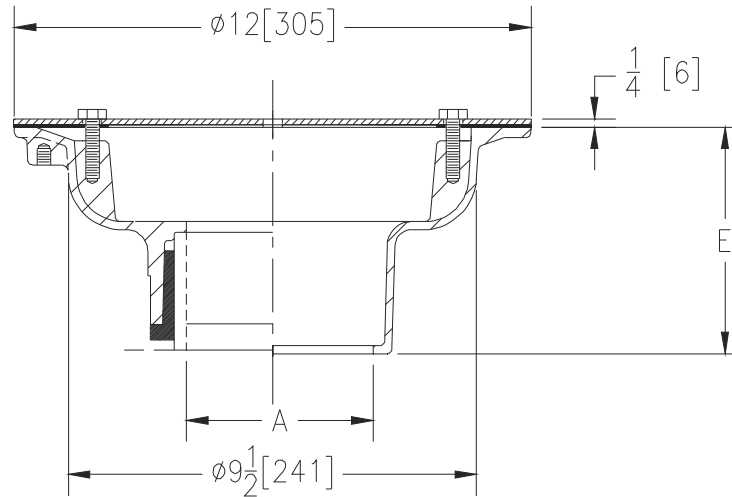

| A- Pipe Size In. [mm] | Approx. Wt. Lbs. [kg] |
|--------------------------|-----------------------------|
| 2,3,4,6 [51,76,102,152] | 22 [10] |

ENGINEERING SPECIFICATION: ZURN Z121-121
12" [305 mm] diameter roof drain. Dura-Coated cast iron body with gasketed stainless steel cover.

OPTIONS (Check/specify appropriate options)

| PIPE SIZE | (Specify size/type) | OUTLET | E BODY HT. DIM. |
|-------------------------------|---------------------|-----------------|-----------------|
| 2, 3, 4, 6 [51, 76, 102, 152] | _____ | IC Inside Caulk | 5-1/4 [133] |
| 2, 3, 4 [51, 76, 102] | _____ | IP Threaded | 3-3/4 [95] |
| 2, 3, 4, 6 [51, 76, 102, 152] | _____ | NH No-Hub | 5-1/4 [133] |
| 2, 3, 4 [51, 76, 102] | _____ | NL Neo-Loc | 4-5/8 [117] |

PREFIXES

_____ Z D.C.C.I. Body*

SUFFIXES

| | | | |
|-----------|---|-----------|--|
| _____ -AC | Angular Underdeck Clamp | _____ -R | Roof Sump Receiver |
| _____ -C | Underdeck Clamp | _____ -TC | Neo-Loc Test Cap Gasket (2,3,4 [51,76,102] NL Bottom Outlet Only) |
| _____ -DP | Top-Set® Deck Plate (Replaces both the -C and -R) | _____ -XJ | Vertical Expansion Joint (See Z190) |
| _____ -DR | Top-Set® Drain Riser | _____ -90 | 90° Threaded Side Outlet Body (2,3,4,5,6 [51,76,102,127,152]) |
| _____ -DX | Dex-o-tex Flange | | |
| _____ -G | Galvanized Cast Iron | | |

* Regularly furnished unless otherwise specified.